

The background features abstract, overlapping geometric shapes in various shades of green, ranging from light lime to dark forest green. The shapes are primarily triangles and polygons, creating a dynamic, layered effect. The text is centered in a clean, sans-serif font.

# On-Street Bikeway Local Examples

# Dallas Local Examples



**Raised/Separated Bike Lanes**

**Buffered Bike Lanes**

**Curb Separated Bike Lanes**

Houston St.  
Source: City of Dallas

Continental Ave.  
Source: City of Dallas



**Flex posts Separated Two-Way Cycle Track**

Jefferson Viaduct  
Source: NCTCOG

# Dallas - Coming Soon

## Victory/Hi-Line Connection Crossing Under IH35



Hi-Line Connection  
Source: SWA

**Raised/Separated  
Bike Lanes**



Hi-Line Connection  
Source: SWA

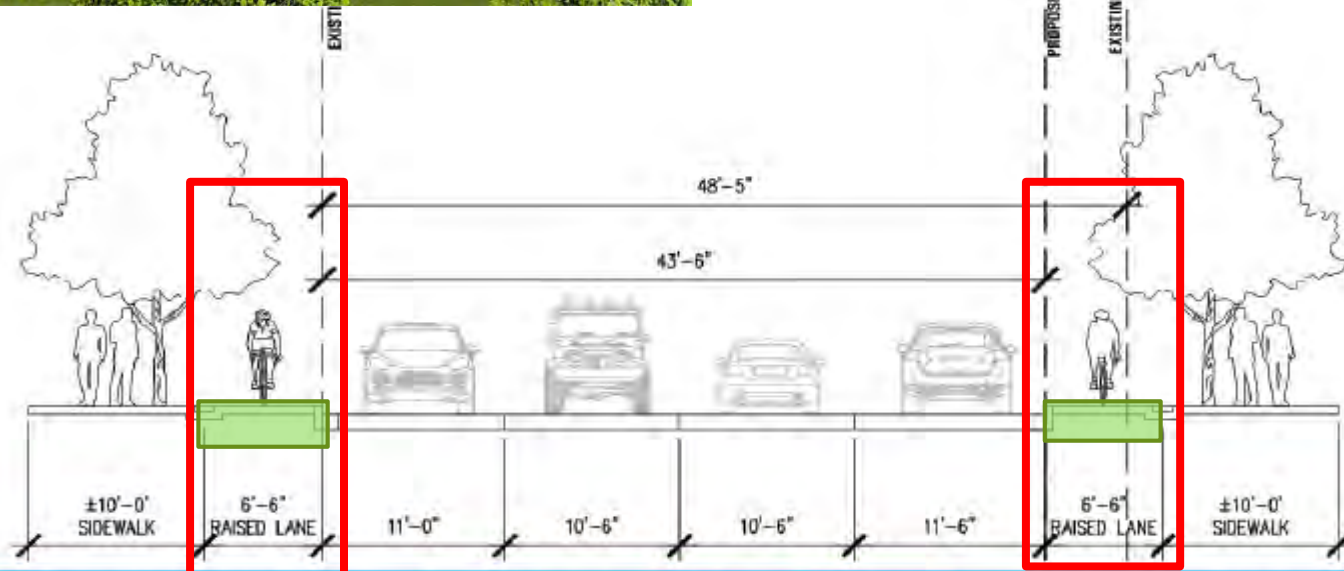

**PROPOSED CONDITION**

Hi-Line Connection  
Source: SWA

# Dallas/Dallas Co. - Coming Soon

## Denton Drive Phase I Raised/Separated Bike Lane

### Planned Improvements

#### Denton Drive Existing Roadway Section

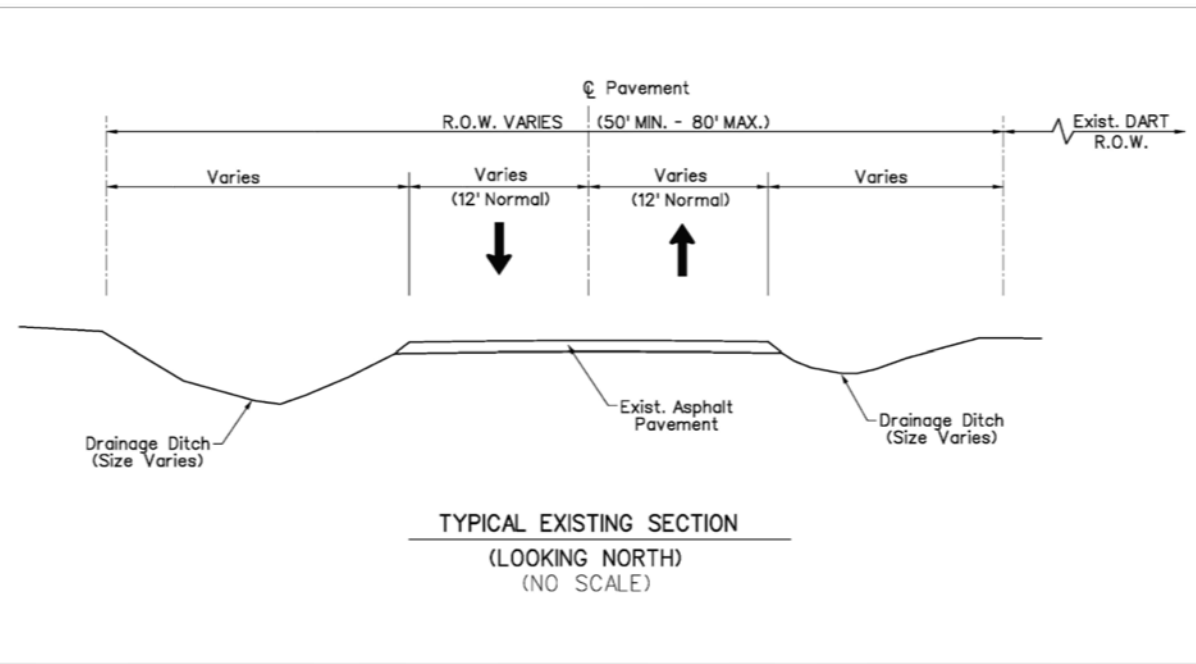

Denton Dr. Improvements  
Source: Dallas County

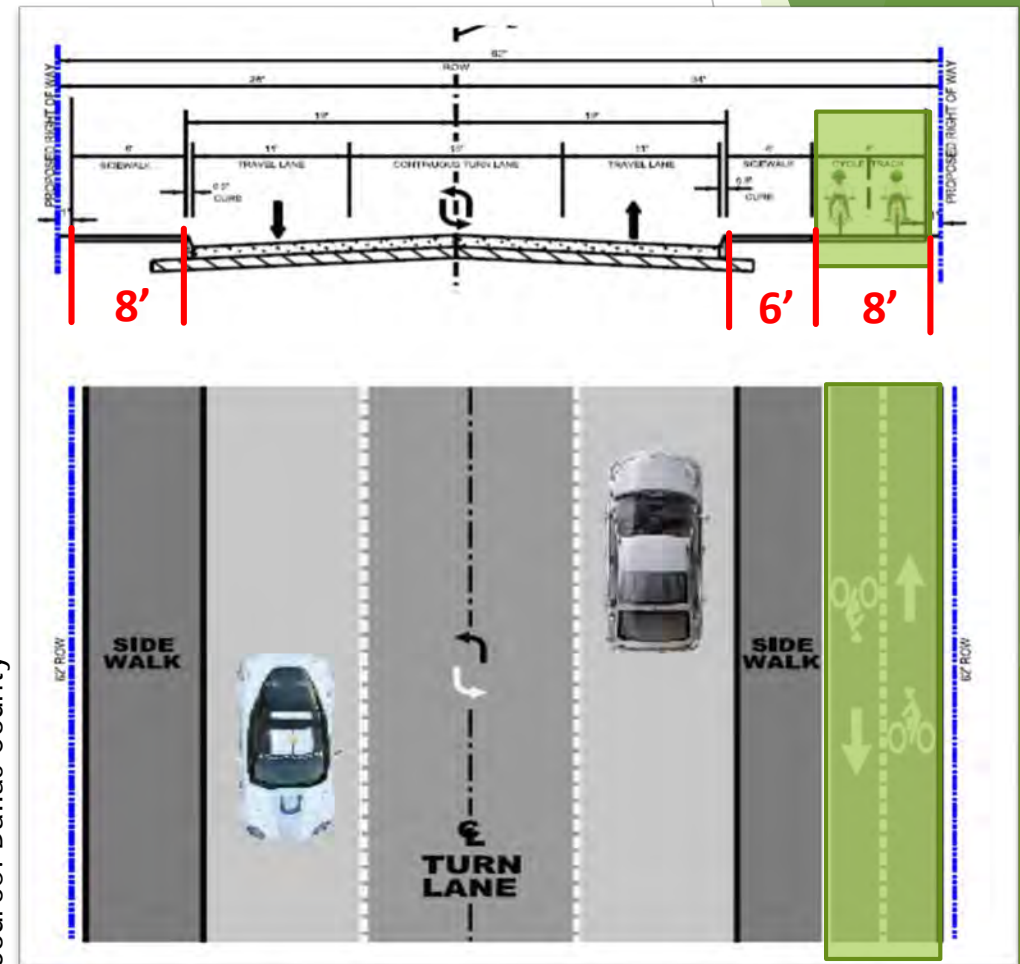

Denton Dr. Improvements  
Source: Dallas County

# Lake Ray Hubbard - Coming Soon

## IH 30 Frontage Roads

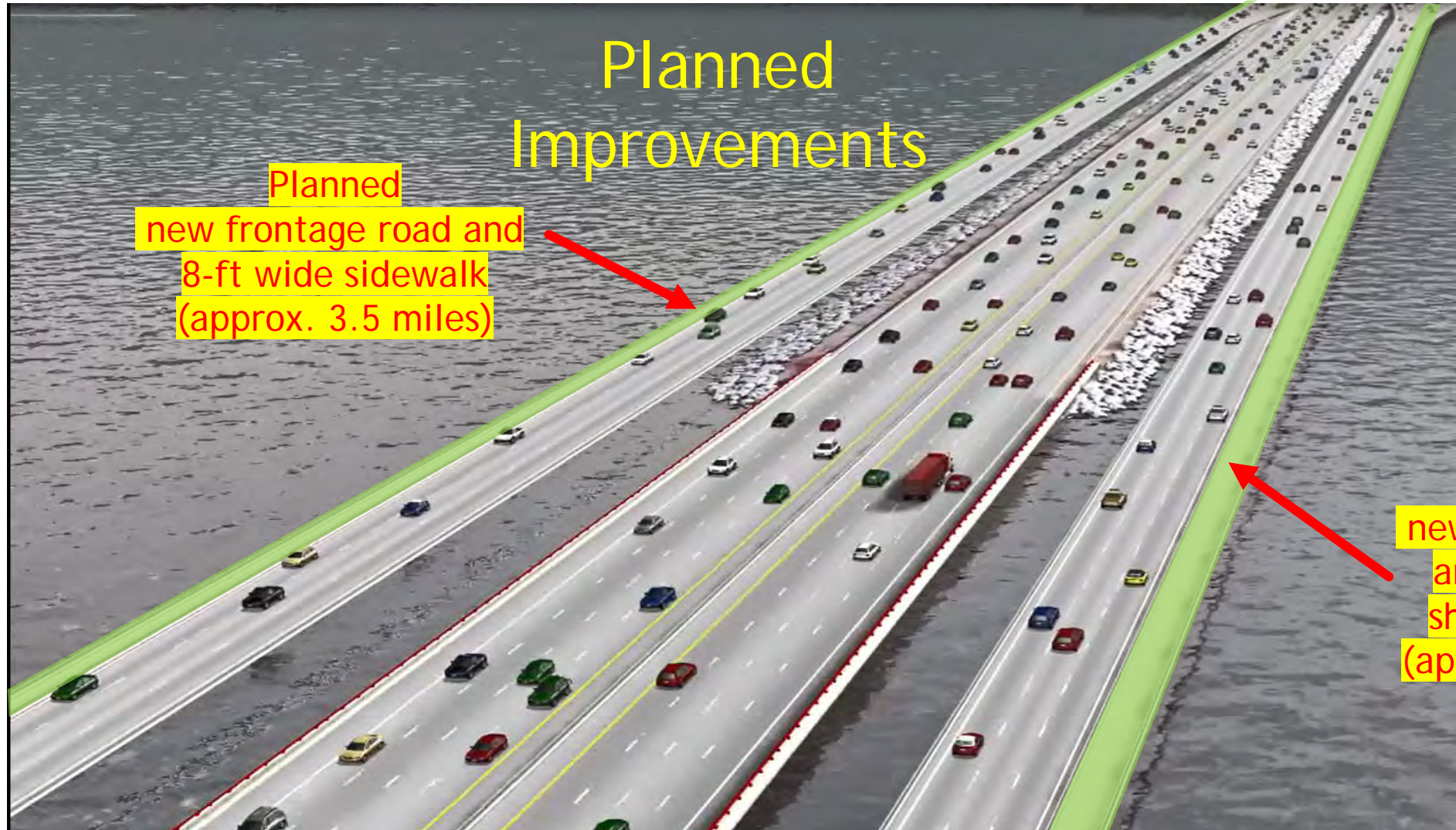

Planned  
Improvements

Planned  
new frontage road and  
8-ft wide sidewalk  
(approx. 3.5 miles)

Planned  
new frontage road  
and 12-ft wide  
shared use path  
(approx. 3.5 miles)

# Lake Ray Hubbard

## IH 30 Frontage Road Bridges

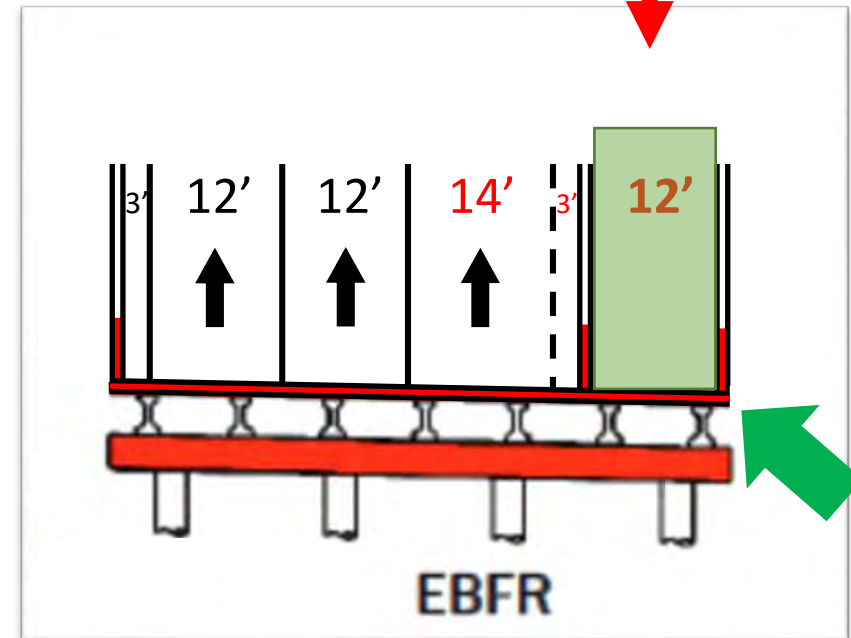
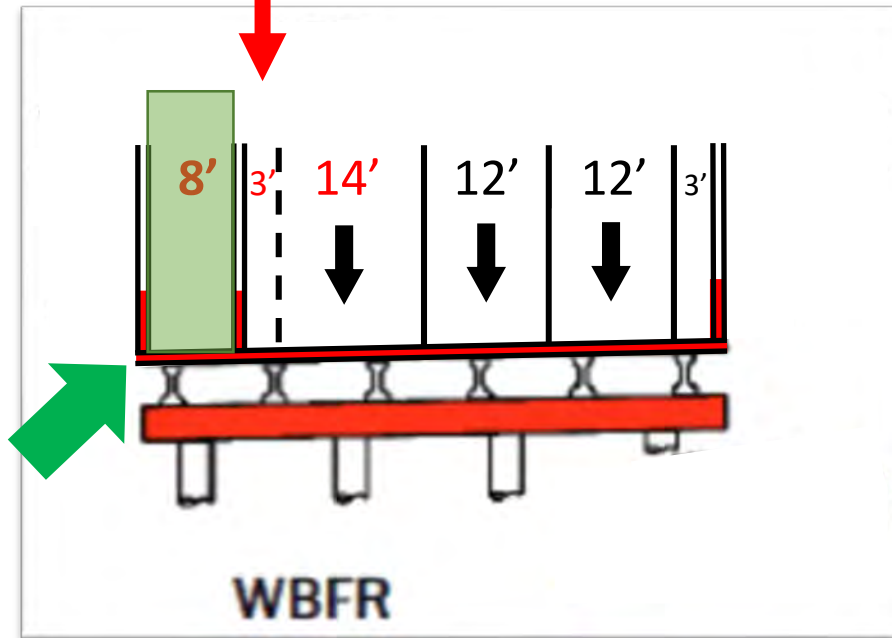
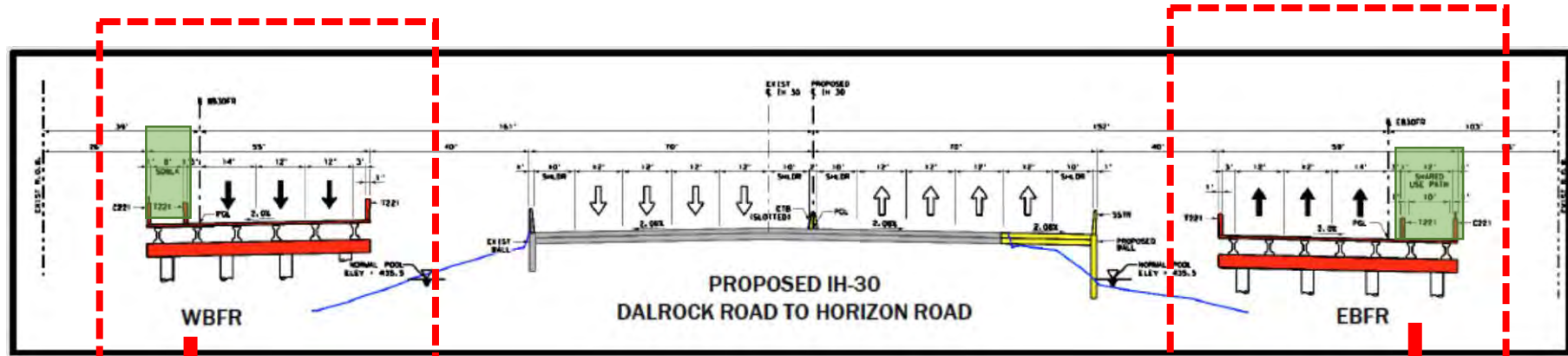

# City of Richardson Local Examples

Road Diet Pilot Project - Convert Outside lanes to Buffered Bike Lanes



Greenville Ave.  
Source: City of Richardson



Greenville Ave.  
Source: Richard Wezensky

# City of Fort Worth Local Examples



**Buffered Bike Lanes**

Main St.

Source: City of Fort Worth



**Reflective Bulb Separated Two-way Cycle Track**

W.10th St.

Source: City of Fort Worth

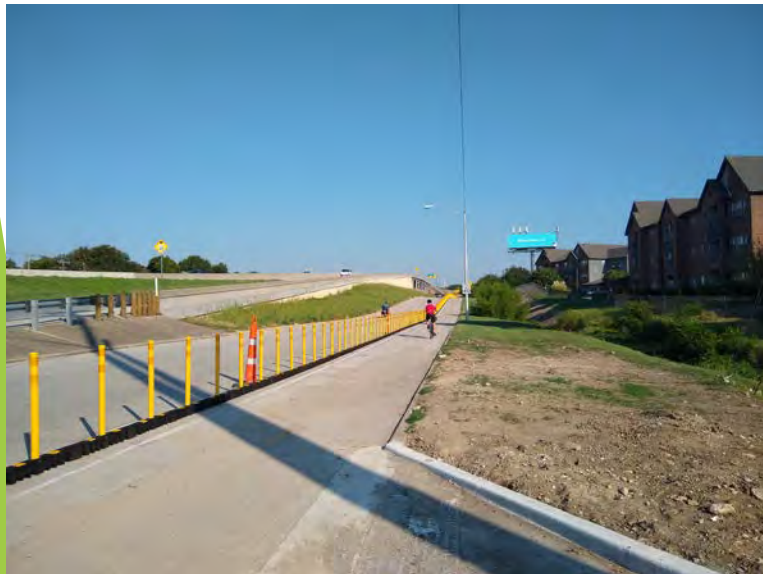

**Frontage Rd.  
Lane Converted to a  
separated Two-Way Cycle  
Track with Flex Post and  
Flex Curb**

SW Blvd.(SH183)

Source: City of Fort Worth

**Major Arterials with Sidepaths**

Timberland Blvd.

Source: City of Fort Worth

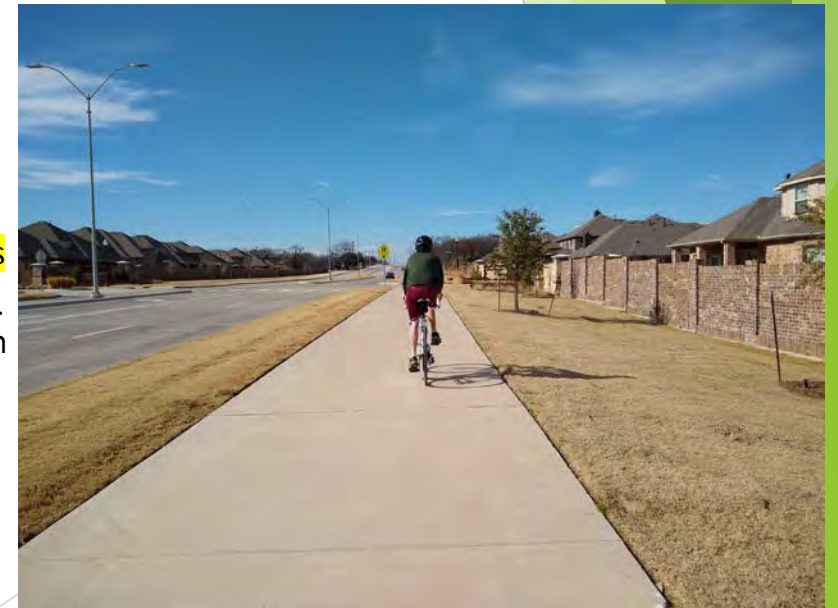



# Richland Hills/TxDOT Fort Worth Local Example

## Baker Blvd. (SH 183)

Added bike lanes  
and wide sidewalks



Baker Blvd. Bike Lanes  
Source: TxDOT Fort Worth District

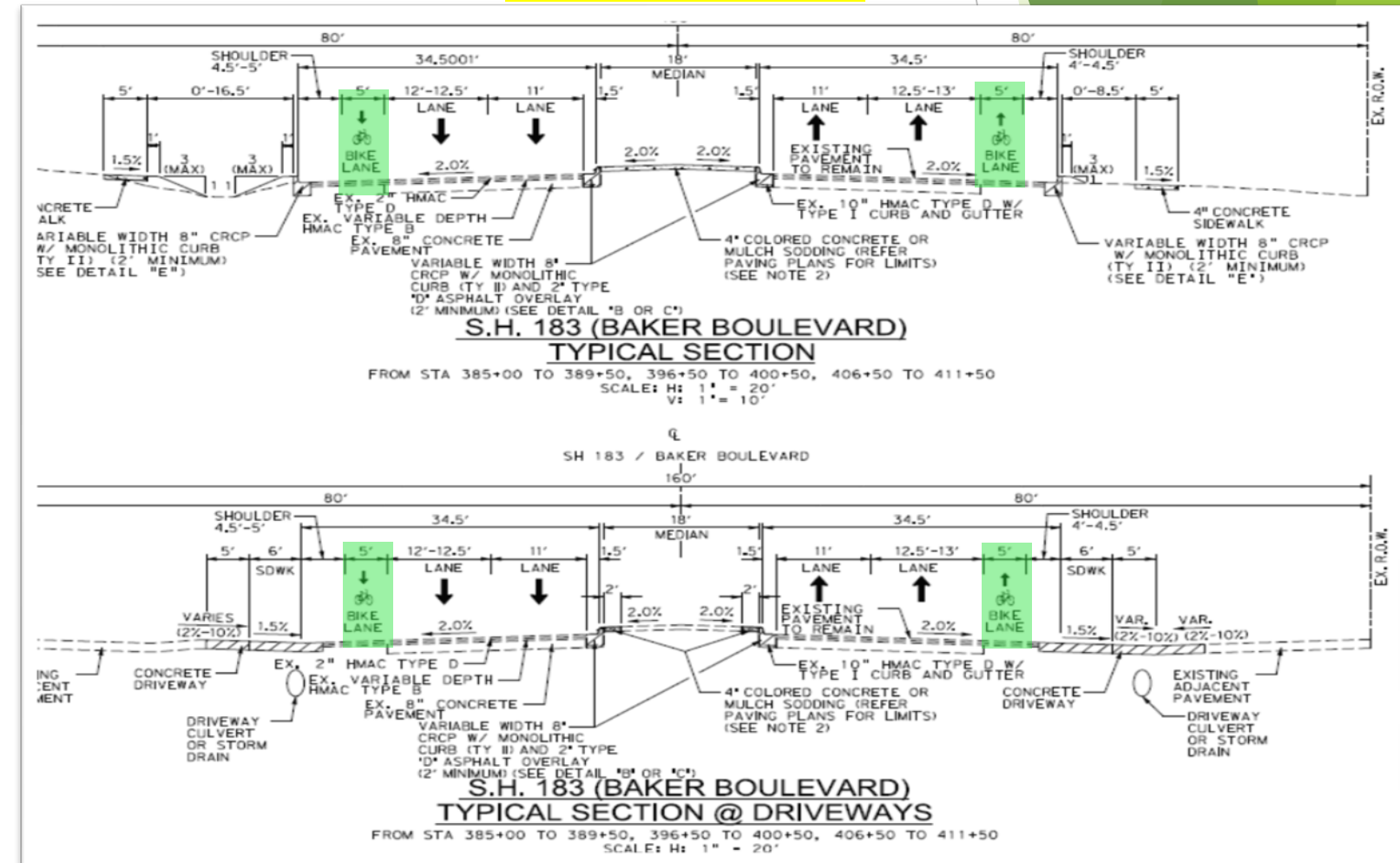

Source: TxDOT Fort Worth District

# (IH20/IH820 & US287) - Coming Soon

## Southeast Connector (Fort Worth, Arlington, Kennedale)

### Draft Typical Sections

### Bike Lanes w/Striped Buffer

### Min-10ft wide Shared use path

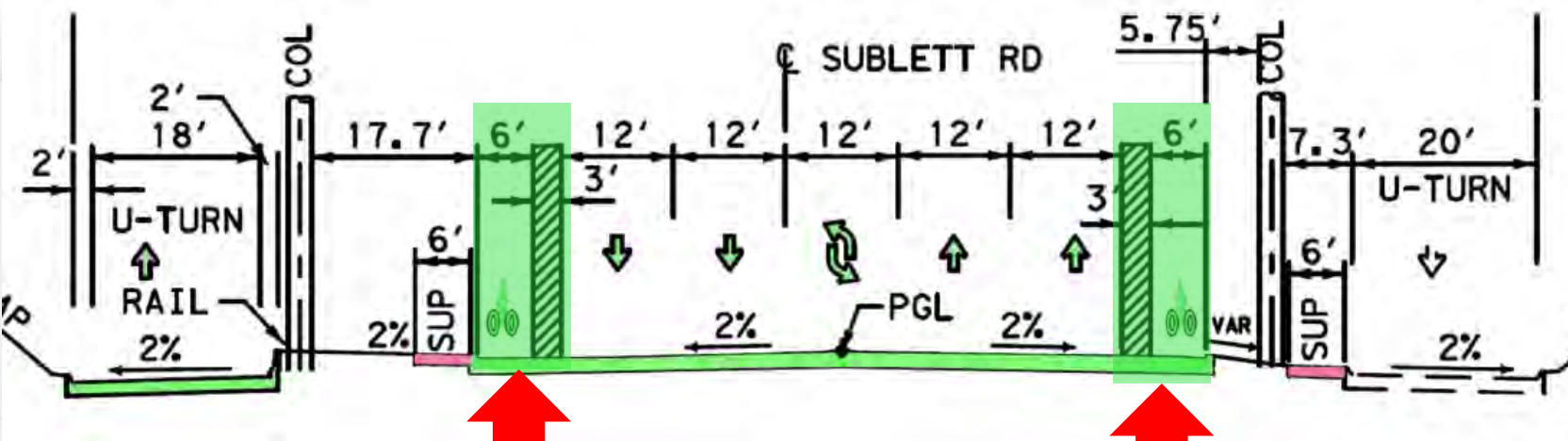
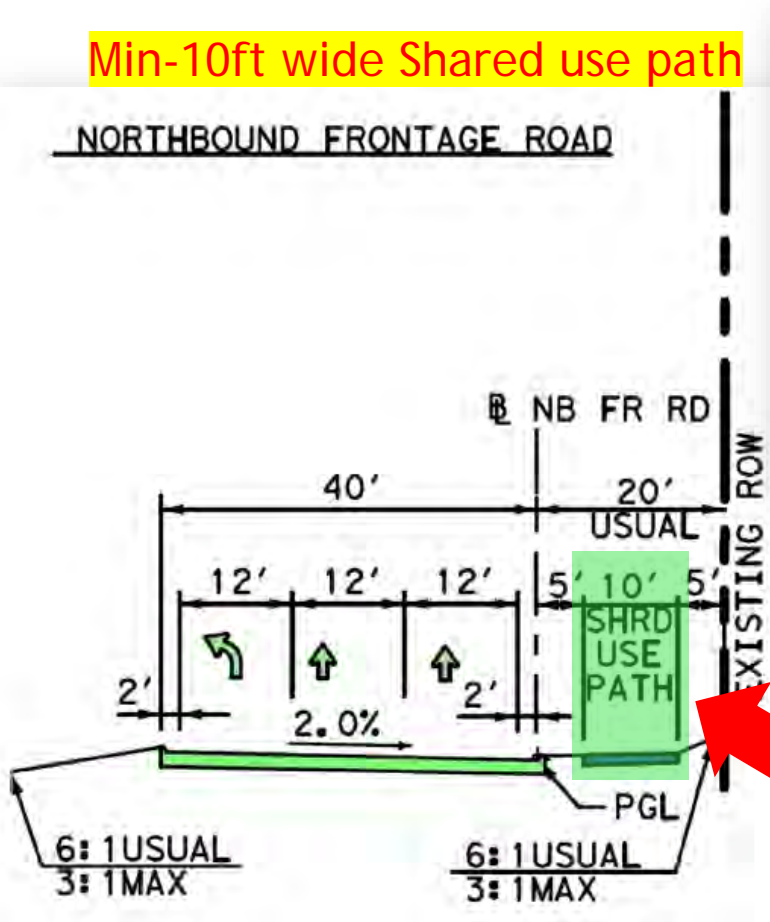

Southeast Connector  
Source:  
TxDOT Fort Worth District

Southeast Connector  
Source: TxDOT Fort Worth District