

Garland ISD Application & Reporting for Door Security Audits



James Walker, Robert Oleson & Mark Quinn - Garland ISD

Garland ISD

3 Cities,
71 Campuses
52,000 Students
No Limits on Learning

And Multiple Doors per
Campus...

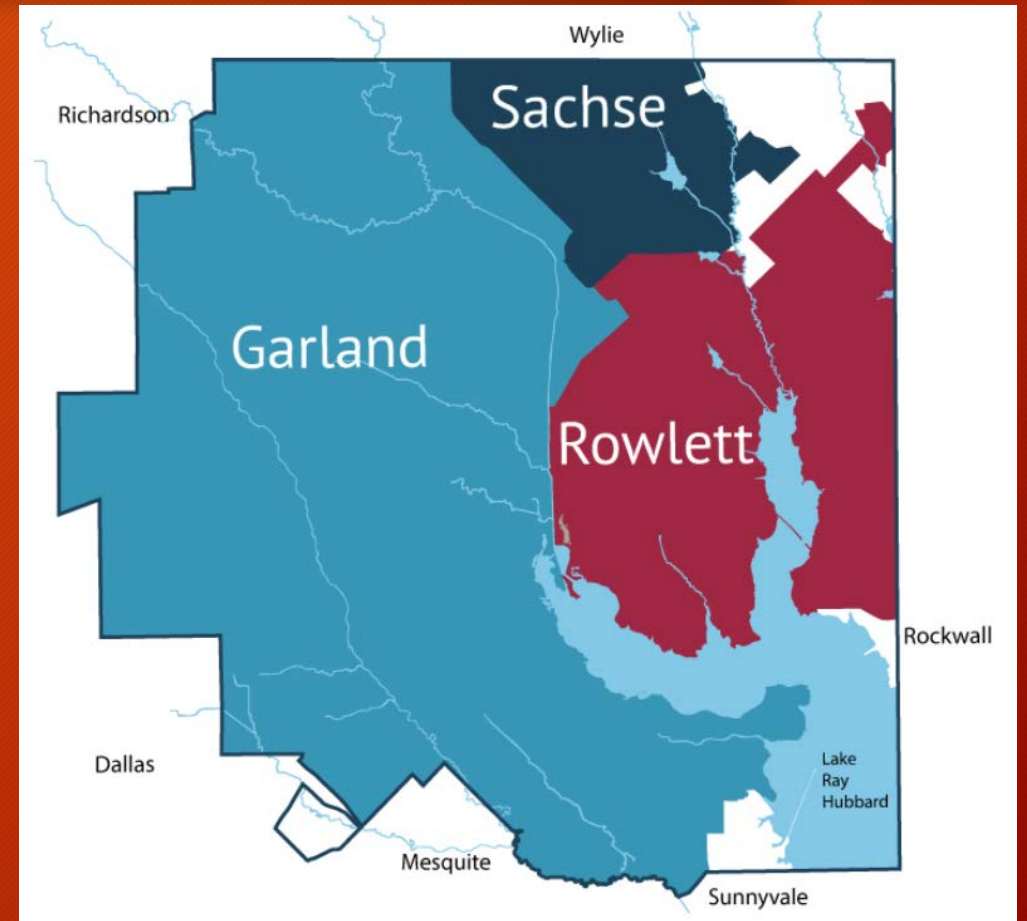

CAD to GIS

For several years we have had our School floorplans in our GIS system.

We extract and build our GIS feature classes from our CAD drawings of each facility.

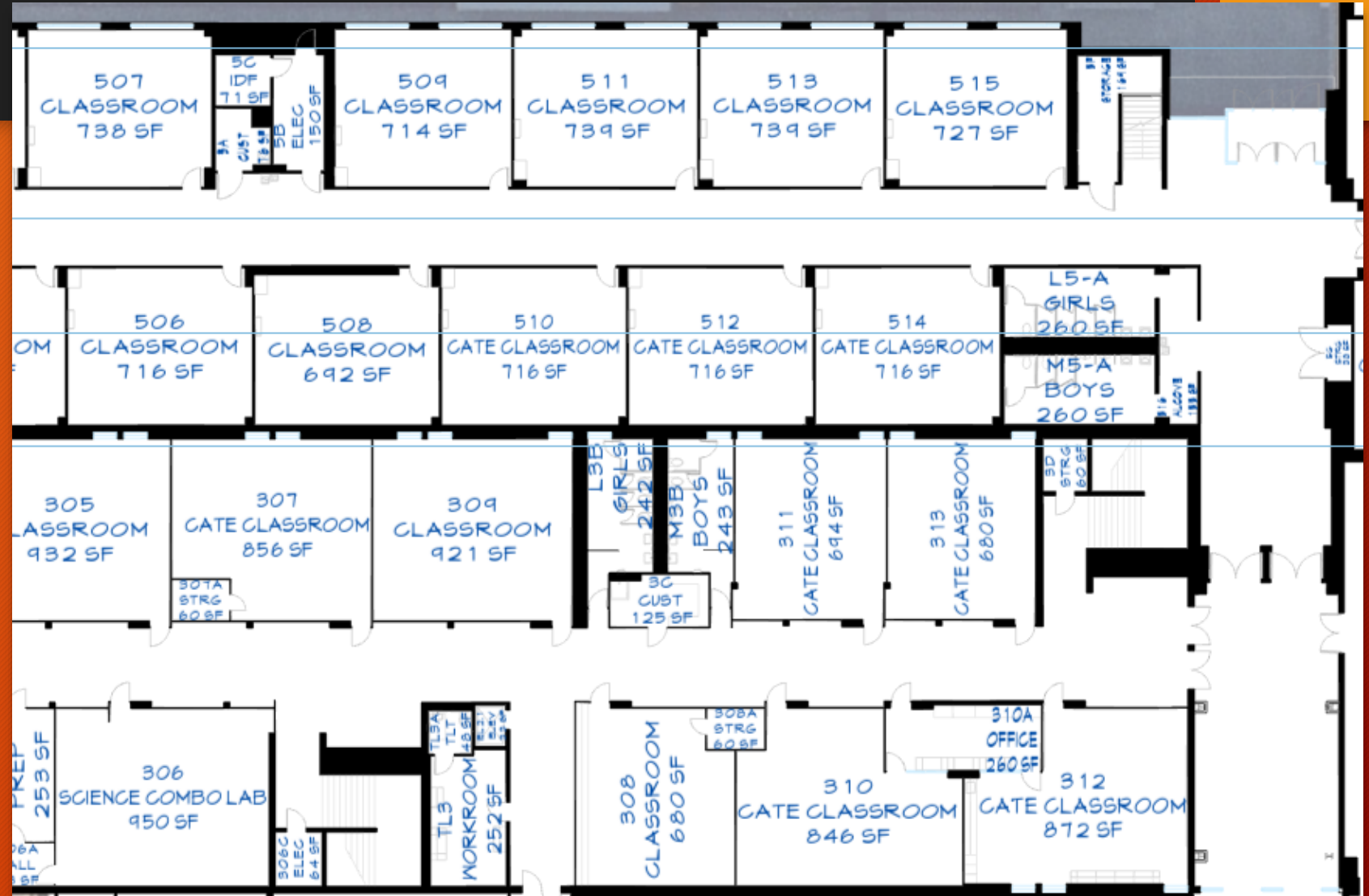

Security Data

Last year we were working on digitizing various assets for security.

Cameras

Motion Sensors

Fire Extinguishers

PA System

Etc...

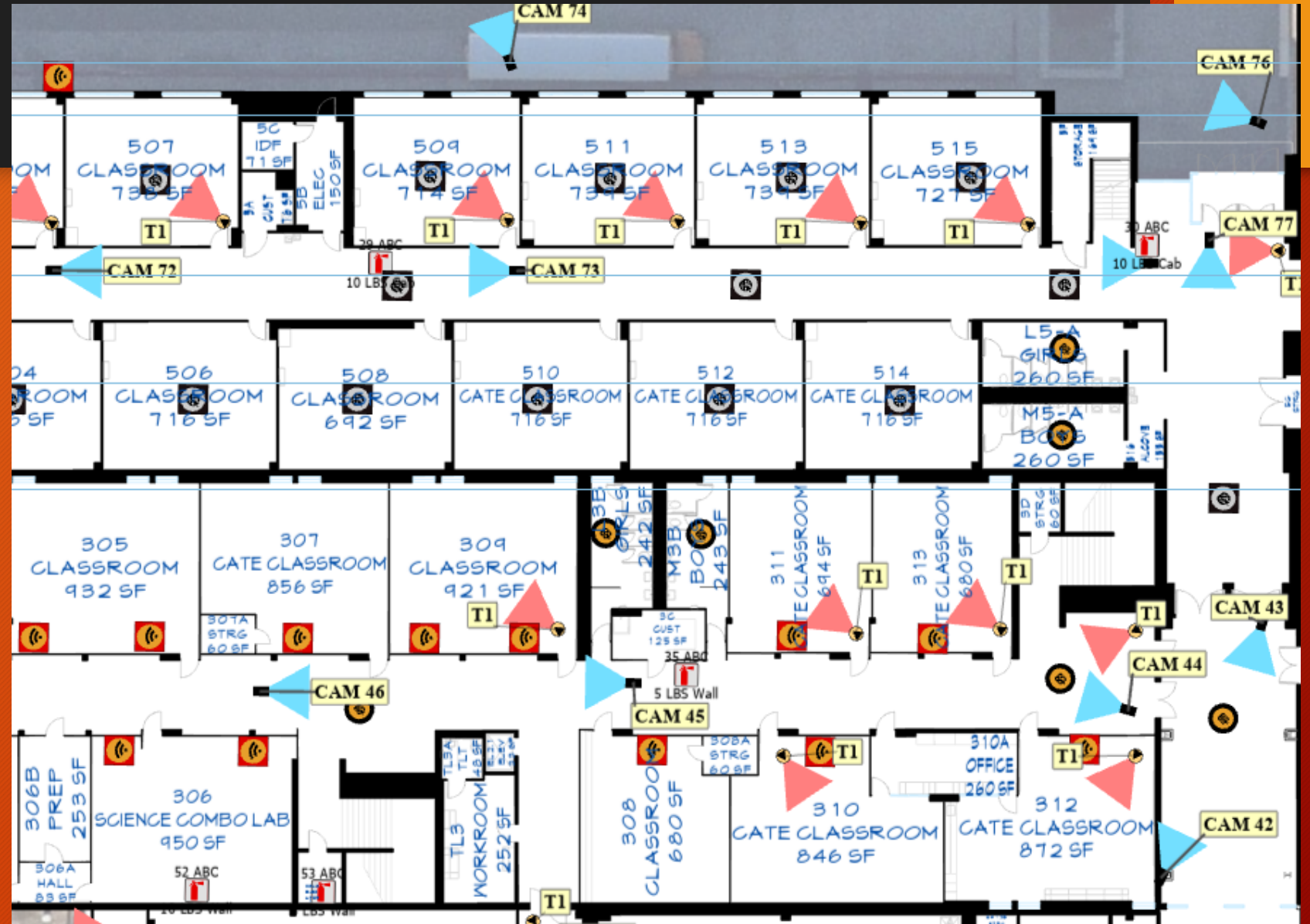

Doors

One of the data sets we were updating was door entry numbers.

Doors are numbered clockwise around the building perimeter to aid emergency responders when they need to quickly find a particular entrance.

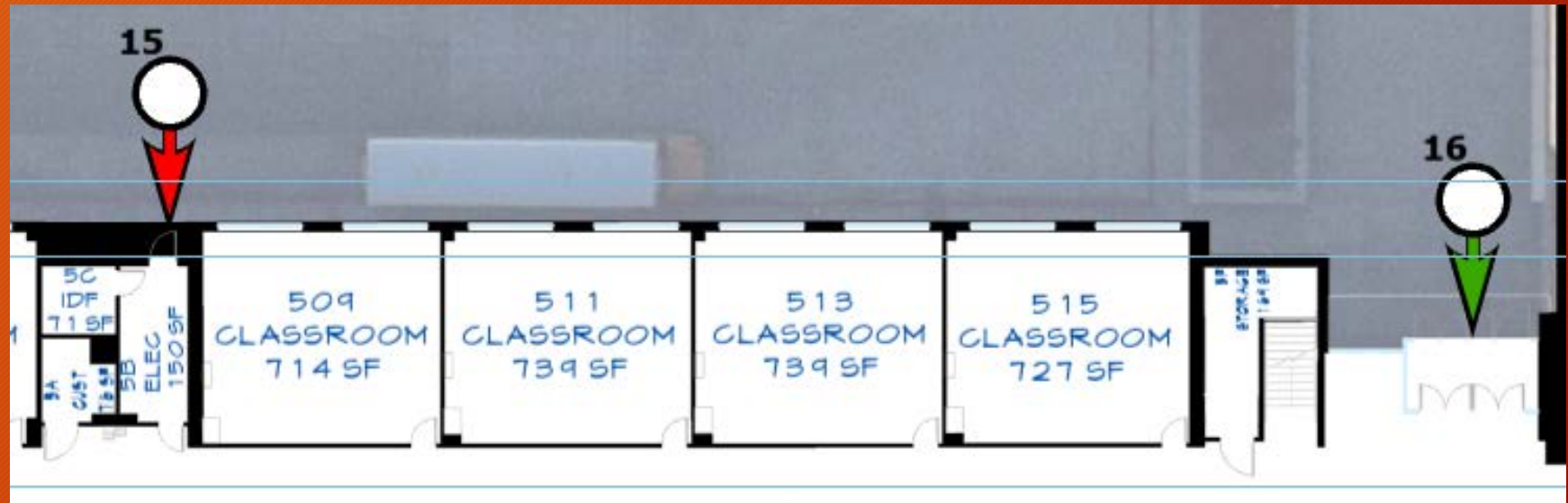

On our maps a green entry has an electronic card reader and a red entry does not.

Then there was a tragedy in south Texas and school doors became an issue on every news station.

Unlocked Doors Were 'First Line of Defense' at Uvalde School

The Uvalde massacre began after the 18-year-old gunman entered the school through a door that could only be locked from the outside and then got inside a classroom that had a busted lock.

By [Associated Press](#) | June 22, 2022, at 8:18 p.m.

HPM Houston Public Media
<https://www.houstonpublicmedia.org> › 2022/05/26

Uvalde gunman walked through apparently unlocked door, ...
May 26, 2022 — During the siege, which ended when a U.S. Border Patrol team burst in and shot the gunman to death, frustrated onlookers urged police ...

Reuters
<https://www.reuters.com> › world › classroom-door-uvald...

Classroom door in Uvalde school shooting was not locked, ...
Jun 21, 2022 — The classroom **door** in the **Uvalde** elementary school where 19 children and two teachers were killed in May was not locked even as police ...

KENS 5
<https://www.kens5.com> › uvalde-school-shooting › ro...

Lawmakers fear flawed Uvalde school doors could be ...
Jun 23, 2022 — Texas police leaders say it's "ridiculous and inexcusable" that the **doors** at Robb Elementary school could only lock from the outside.

INVESTIGATIONS

Unlocked door in Uvalde school shooting raises questions about Texas safety requirements

by: [Avery Travis](#)
Posted: May 26, 2022 / 09:39 PM CDT
Updated: May 26, 2022 / 09:53 PM CDT

Jim Vertuno, Associated Press

Texas police say Uvalde teacher closed door before attack but it didn't lock

Leave your feedback

Share

Nation May 31, 2022 6:16 PM EDT

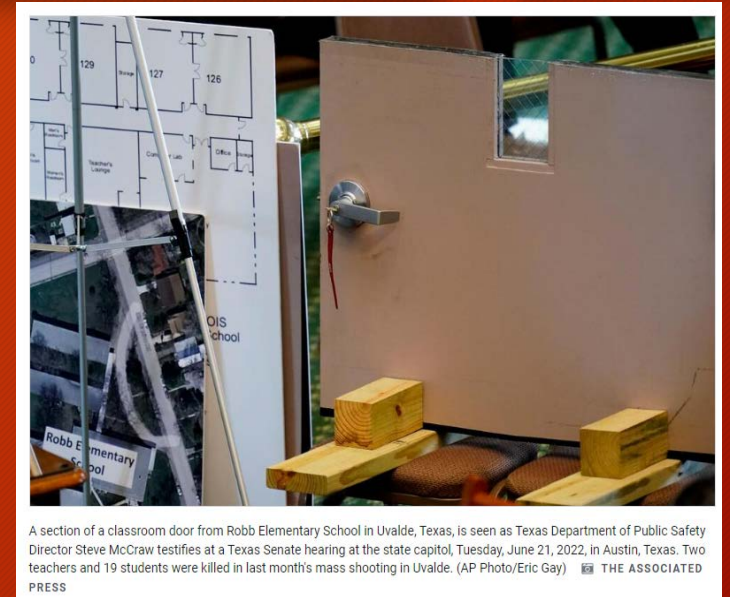

A section of a classroom door from Robb Elementary School in Uvalde, Texas, is seen as Texas Department of Public Safety Director Steve McCraw testifies at a Texas Senate hearing at the state capitol, Tuesday, June 21, 2022, in Austin, Texas. Two teachers and 19 students were killed in last month's mass shooting in Uvalde. (AP Photo/Eric Gay) THE ASSOCIATED PRESS

- <https://apnews.com/article/politics-shootings-texas-school-safety-2c97d26b56e8b081aa725ee2235e4a3b>
- https://www.google.com/search?safe=active&q=unlocked+door+uvalde&rlz=1C1CHBF_enUS816US816&oq=unlocked+door+uvalde&aqs=chrome..69157j0i2213014j6916l_4335j0j7&sourceid=chrome&ie=UTF-8#ip=1
- <https://www.usnews.com/news/us/articles/2022-06-21/secure-doors-were-first-line-of-defense-at-uvalde-school>
- <https://www.kxan.com/investigations/unlocked-door-in-uvalde-school-shooting-raises-questions-about-texas-safety-requirements/>
- <https://www.pbs.org/newshour/nation/texas-police-say-uvalde-school-teacher-closed-propped-open-door-before-attack-but-it-didnt-lock>

Door security audits were mandated

GIS had meetings with both GISD Maintenance and GISD Security to discuss what needed to be done.

<https://www.texastribune.org/2022/06/01/texas-greg-abbott-school-security-ualde/>

THE TEXAS TRIBUNE INVESTIGATIONS NEWSLETTERS EVENTS AUDIO DATA

UVALDE SCHOOL SHOOTING

Gov. Greg Abbott instructs school safety officials to conduct “unannounced, random intruder” audits of Texas public schools

Abbott has tasked the Texas School Safety Center with conducting in-person, unannounced audits of public schools to see how quickly staff can enter a building without being stopped and detect weak points.

BY **KATE MCGEE** JUNE 1, 2022 UPDATED: 8 PM CENTRAL

[f](#) [t](#) [✉](#) [COPY LINK](#) [REPUBLISH](#)



TEA sent out instructions

EXTERIOR DOOR COMPONENTS

This page is intended to help school districts understand and identify the minimum door standard components and requirements for standard hinge door types. The images used are examples only and are not to be considered the only option or type of that specific component.

The following components should be checked to see if operable on all exterior building hinge door types.

Component	Image	Description	Review Process
Sturdy Mullion (Double Door Only)		If part of exit of double doors, sturdy center mullion.	With both doors open, push and pull the mullion. The mullion should be sturdy and not move.
Reinforced Door Frame		Constructed of solid material (typically metal) that can't be easily breached.	Confirm that the frame is made of solid material.
Auto Door Closer		A mechanism that fully closes automatically after entry or egress without manual intervention, regardless of air pressure within or outside of the facility.	To ensure this mechanism properly works, the release air conditioning unit should be on to create positive airflow of air pressure. Then open the door fully, then door should automatically shut completely, and latch.
Auto Door Lock		A mechanism that fully engages locking hardware automatically after entry or egress without manual intervention.	Open the door, after the door closes, it should be back latched and locked from the outside. Someone on the outside must confirm that the door is locked externally.
Emergency Open Mechanism		A mechanism that allows the door to be opened from the inside when locked, without a key, and the door remains locked.	With the door locked, the door should be able to be opened from the inside. After it is opened from the inside, it should remain locked from the outside after locked from the inside.
All Non-Hinged Doors		Any door that is not a hinge door should be verified that it can close and lock.	Physically confirm that the door can close and lock. This information will not be collected on the Door Audit Sheet.



Search

[A - Z Index](#) [Contact](#) [Employment](#) [Sign Up for Updates](#) [TEA Correspondence](#)



About TEA



Texas Schools



Academics



Finance & Grants



Reports & Data



Student Assessment



Texas Educators

[Home](#) / [About TEA](#) / [News & Multimedia](#) / [To The Administrator Addressed Correspondence](#)

Required School Safety Action Steps This Summer

[taa-required-school-safety-action-steps-this-summer.pdf](#)

Date: June 30, 2022

Subject: Required School Safety Action Steps Th

Category: School Safety

Next Steps: Begin actions related to safety audits, i

Sample Facility Exterior Door Identification

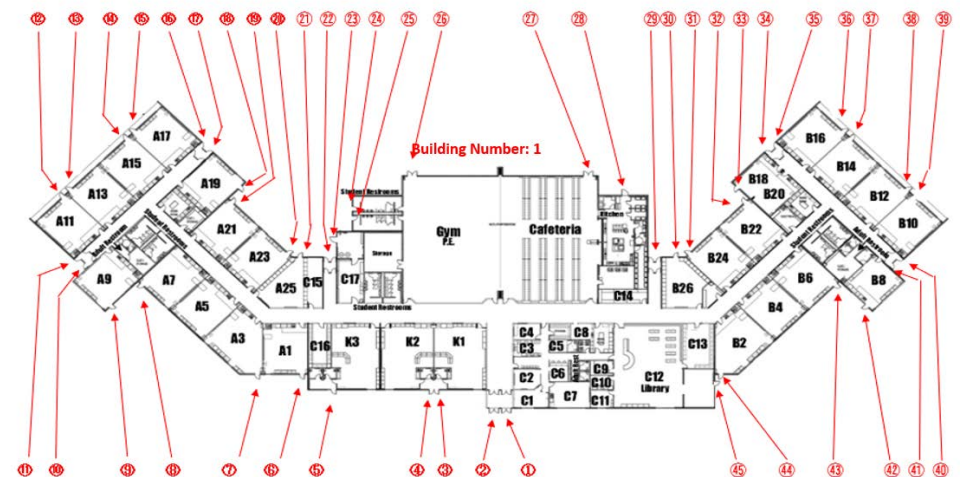

<https://tea.texas.gov/about-tea/news-and-multimedia/correspondence/taa-letters/required-school-safety-action-steps-this-summer>

We had to assess our data

Exterior Door Safety Audit Tracker

This tool is designed to help educational leaders perform an exterior door audit to identify security risks to their campus. Individuals performing the exterior door should assess whether or not each of the door safety components are:

Operational (O) Put an **O** in the cell if the component **works** as intended.

Non-Operational (NO) Put an **NO** in the cell if the component **does not work** as intended.

Not Present (NP) Put an **NP** in the cell if this component is **not present**.

Not Applicable (NA) Only put **NA** for Sturdy Mullion on all single doors

Note: Your campus identifier, building number, and door number convention may differ from the example below.

Campus	Building	Door Number	Sturdy Mullion <small>(Double Doors Only - Put NA for all other doors)</small>	Reinforced Door Frames	Auto Door Closer	Auto Door Lock	Emergency Open Mechanism
Example01	E1	1.1	O	O	O	O	O
Example01	E1	1.2	NA	O	NO	O	NP

Certain assets needed to be inventoried for every exterior door. We met with Maintenance and Security again to discuss what data we had and what needed to be collected.

More detail in door data

Instead of just marking the numbered door entries on our map we now identify the numbered entry with a polygon and each individual door as a point within that entry. Mullions are also a separate point feature class since they exist between two doors.

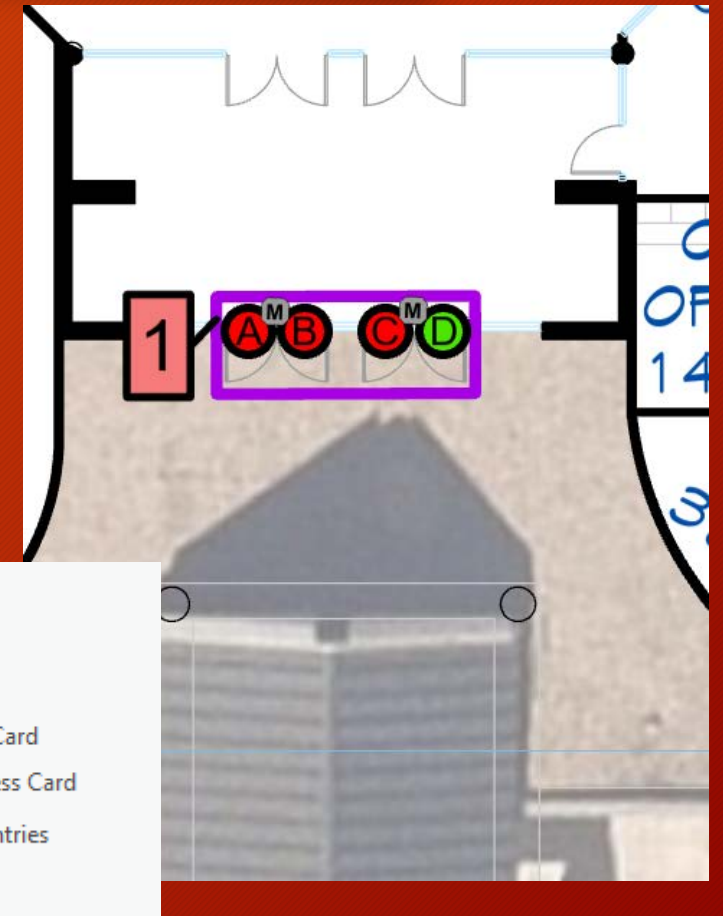
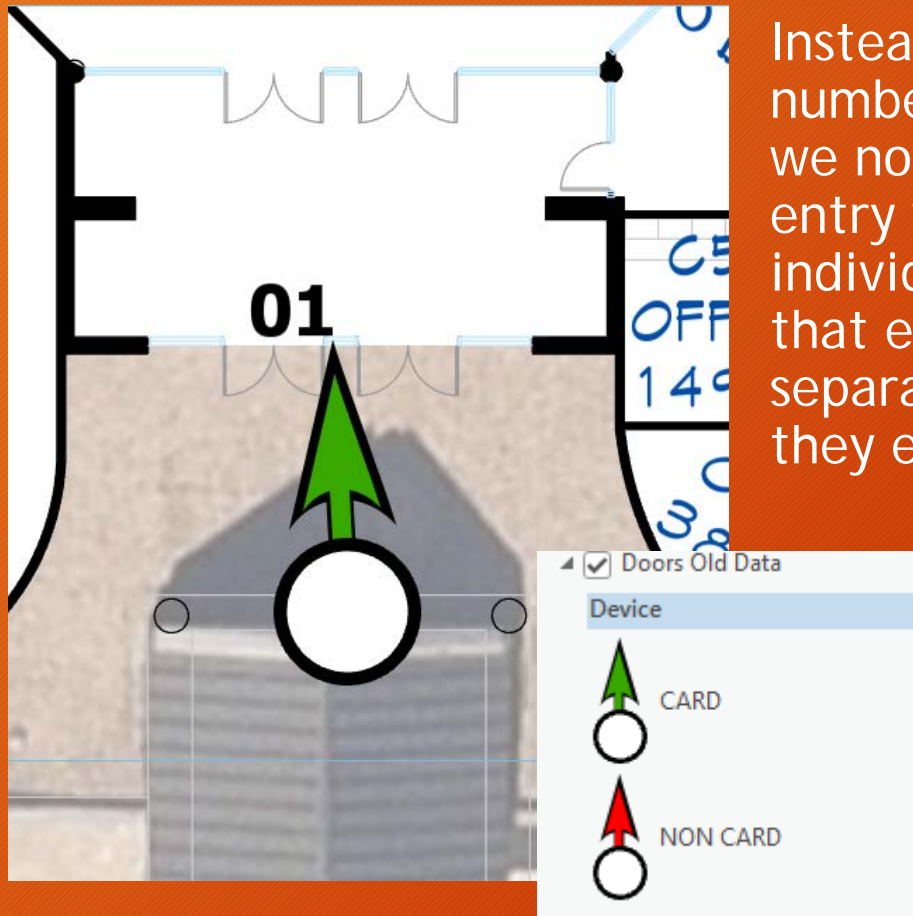

More detail in door data

DOORS

Field: Add Calculate Selection: Select By Attributes Zoom To Switch Clear Delete Copy

	Loc	CampusID	Building	Lev	PortID	BuildID	CampLev	Entry	CampEntry	Door	AccessCard	DoorID	DoorType	Door Material	Swing	HingeType	AutoCloser	EmerOpen	AutoLock	Interior Hardware	KeySystem	OHLockable	OHLockType	Azimuth	SORT1	EntryURL	Notes
1	002	002.1	A	1st	<Null>	002.1_A	002.1_1	1	002.1_1	A	No Access Card	002.1_1_A	WALK	HOLLOW METAL	R	CONTINUOUS HINGE	Y	<Null>	Y	SARGENT-PUSH	NKD	<Null>	<Null>	<Null>	Solid door	http://gisfiles/EntriesAndDoors/002/1	<Null>
2	002	002.1	A	1st	<Null>	002.1_A	002.1_1	1	002.1_1	B	Access Card	002.1_1_B	WALK	HOLLOW METAL	L	CONTINUOUS HINGE	Y	<Null>	Y	SARGENT-PUSH	MEDECO	<Null>	<Null>	<Null>	Solid door	http://gisfiles/EntriesAndDoors/002/1	<Null>
3	002	002.1	A	1st		002.1_A	002.1_1	10	002.1_10	A	No Access Card	002.1_10_A	OVERHEAD	METAL	<Null>	OTHER	<Null>	<Null>	<Null>	PULL CHAIN	<Null>	Y	CHAIN LOCK	<Null>	Solid door	http://gisfiles/EntriesAndDoors/002/10	<Null>
4	002	002.1	A	1st	<Null>	002.1_A	002.1_1	11	002.1_11	A	No Access Card	002.1_11_A	WALK	HOLLOW METAL	R	CONTINUOUS HINGE	Y	<Null>	Y	SARGENT-PUSH	MEDECO	<Null>	<Null>	<Null>	Window less than 50%	http://gisfiles/EntriesAndDoors/002/11	<Null>
5	002	002.1	A	1st	<Null>	002.1_A	002.1_1	12	002.1_12	A	No Access Card	002.1_12_A	OVERHEAD	METAL	<Null>	OTHER	<Null>	<Null>	<Null>	<Null>	RUSSWIN	Y	RUSSWIN	<Null>	Solid door	http://gisfiles/EntriesAndDoors/002/12	<Null>
6	002	002.1	A	1st	<Null>	002.1_A	002.1_1	13	002.1_13	A	No Access Card	002.1_13_A	WALK	HOLLOW METAL	L	CONTINUOUS HINGE	Y	<Null>	Y	SARGENT-PUSH	MEDECO	<Null>	<Null>	<Null>	Window less than 50%	http://gisfiles/EntriesAndDoors/002/13	<Null>
7	002	002.1	A	1st	<Null>	002.1_A	002.1_1	14	002.1_14	A	No Access Card	002.1_14_A	WALK	HOLLOW METAL	R	CONTINUOUS HINGE	Y	<Null>	Y	SARGENT-PUSH	NKD	<Null>	<Null>	<Null>	Window less than 50%	http://gisfiles/EntriesAndDoors/002/14	<Null>
8	002	002.1	A	1st	<Null>	002.1_A	002.1_1	14	002.1_14	B	No Access Card	002.1_14_B	WALK	HOLLOW METAL	L	CONTINUOUS HINGE	Y	<Null>	Y	SARGENT-PUSH	MEDECO	<Null>	<Null>	<Null>	Window less than 50%	http://gisfiles/EntriesAndDoors/002/14	<Null>
9	002	002.1	A	1st	<Null>	002.1_A	002.1_1	15	002.1_15	A	No Access Card	002.1_15_A	WALK	HOLLOW METAL	L	CONTINUOUS HINGE	Y	<Null>	Y	SARGENT-PUSH	MEDECO	<Null>	<Null>	<Null>	Window less than 50%	http://gisfiles/EntriesAndDoors/002/15	<Null>
10	002	002.1	A	1st	<Null>	002.1_A	002.1_1	16	002.1_16	A	No Access Card	002.1_16_A	OVERHEAD	METAL	<Null>	OTHER	<Null>	<Null>	<Null>	PULL CHAIN	CHAIN DOOR LOCK	Y	CHAIN LOCK	<Null>	Solid door	http://gisfiles/EntriesAndDoors/002/16	<Null>
11	002	002.1	A	1st	<Null>	002.1_A	002.1_1	17	002.1_17	A	No Access Card	002.1_17_A	WALK	HOLLOW METAL	L	CONTINUOUS HINGE	Y	<Null>	Y	HANDLE	MEDECO	<Null>	<Null>	<Null>	Solid door	http://gisfiles/EntriesAndDoors/002/17	<Null>
12	002	002.1	A	1st	<Null>	002.1_A	002.1_1	18	002.1_18	A	No Access Card	002.1_18_A	OVERHEAD	METAL	<Null>	OTHER	<Null>	<Null>	<Null>	<Null>	MEDECO	Y	MEDECO	<Null>	Solid door	http://gisfiles/EntriesAndDoors/002/18	<Null>

Mullions

Field: Add Calculate Selection: Select By Attributes Zoom To Switch Clear Delete Copy Highlighted: Unselect Reselect

	Loc	CampusID	CampEntry	Building	PortID	BuildID	CampLev	Entry	Door1	Door2	Doors	Sturdy	Removable	KEYorSET	MullionID
1	002	002.1	002.1_1	A	<Null>	002.1_A	002.1_1	1	1A	1B	1AX1B	Y	Y	K	002.1_1_1AX1B
2	002	002.1	002.1_14	A	<Null>	002.1_A	002.1_1	14	14A	14B	14AX14B	Y	Y	K	002.1_14_14AX14B
3	002	002.1	002.1_21	A	<Null>	002.1_A	002.1_1	21	21A	21B	21AX21B	Y	Y	K	002.1_21_21AX21B
4	002	002.1	002.1_27	A	<Null>	002.1_A	002.1_1	27	27A	27B	27AX27B	Y	Y	K	002.1_27_27AX27B
5	002	002.1	002.1_41	A	<Null>	002.1_A	002.1_1	41	41A	41B	41AX41B	Y	Y	K	002.1_41_41AX41B
6	002	002.1	002.1_42	A	<Null>	002.1_A	002.1_1	42	42A	42B	42AX42B	Y	Y	S	002.1_42_42AX42B
7	002	002.1	002.1_42	A	<Null>	002.1_A	002.1_1	42	42C	42D	42CX42D	Y	Y	S	002.1_42_42CX42D
8	002	002.1	002.1_43	A	<Null>	002.1_A	002.1_1	43	43A	43B	43AX43B	Y	Y	K	002.1_43_43AX43B

Building Entries

Field: Add Calculate Selection: Select By Attributes Zoom To Switch Clear Delete Copy

	Loc	CampusID	Building	Lev	PortID	BuildID	CampLev	Entry	Doors	CampEntry	ReinFrame	FrameMat	Azimuth	EntryGlass	EntryURL
1	002	002.1	A	1st	<Null>	002.1_A	002.1_1	1	2	002.1_1	<Null>	<Null>	<Null>	Glass beside or above doors	http://gisfiles/EntriesAndDoors/002/1
2	002	002.1	A	1st	<Null>	002.1_A	002.1_1	10	1	002.1_10	<Null>	<Null>	<Null>	Solid	http://gisfiles/EntriesAndDoors/002/10
3	002	002.1	A	1st	<Null>	002.1_A	002.1_1	11	1	002.1_11	<Null>	<Null>	<Null>	Solid	http://gisfiles/EntriesAndDoors/002/11
4	002	002.1	A	1st	<Null>	002.1_A	002.1_1	12	1	002.1_12	<Null>	<Null>	<Null>	Solid	http://gisfiles/EntriesAndDoors/002/12
5	002	002.1	A	1st	<Null>	002.1_A	002.1_1	13	1	002.1_13	<Null>	<Null>	<Null>	Solid	http://gisfiles/EntriesAndDoors/002/13
6	002	002.1	A	1st	<Null>	002.1_A	002.1_1	14	23	002.1_14	<Null>	<Null>	<Null>	Glass beside or above doors	http://gisfiles/EntriesAndDoors/002/14
7	002	002.1	A	1st	<Null>	002.1_A	002.1_1	15	1	002.1_15	<Null>	<Null>	<Null>	Solid	http://gisfiles/EntriesAndDoors/002/15
8	002	002.1	A	1st	<Null>	002.1_A	002.1_1	16	1	002.1_16	<Null>	<Null>	<Null>	Solid	http://gisfiles/EntriesAndDoors/002/16
9	002	002.1	A	1st	<Null>	002.1_A	002.1_1	17	1	002.1_17	<Null>	<Null>	<Null>	Solid	http://gisfiles/EntriesAndDoors/002/17

Maintenance collected the door data and took photos which we placed on a server.

gisfiles - /EntriesAndDoors/002/1/

[\[To Parent Directory\]](#)

8/2/2022 6:39 AM 5426333 [002 - Entry 1 Exterior.JPG](#)
 8/2/2022 6:39 AM 5494293 [002 - Entry 1 Interior.JPG](#)

Campus GHS

Entry Number	Number of doors	Door ID	Access Card	Door Type	Walk / Over	Swing	Key System	Interior Hardware	Mullion Secure	Auto door closer	Auto door lock
1	2	(A)	Y (N)	A/(M)W	Walk/OH	L (R)	NO	SPB	(Y) N	(Y) N	(Y) N
		(B)	(Y) N	A/M/W	Walk/OH	(L) R	med	SPB	Mullion Removable	Overhead Door	
Hinges per door		∅	Y / N	A / M / W	Walk / OH	L / R			(Y) N	Manual	Electric
(1)~2~3~4		∅	Y / N	A / M / W	Walk / OH	L / R			Set screw or Key	Lock	Y / N

Entry Number	Number of doors	Door ID	Access Card	Door Type	Walk / Over	Swing	Key System	Interior Hardware	Mullion Secure	Auto door closer	Auto door lock
2	1	(A)	Y (N)	A/(M)W	Walk/OH	(L) R	med	SPB	Y / N	(Y) N	(Y) N
		∅	Y / N	A / M / W	Walk / OH	L / R			Mullion Removable	Overhead Door	
Hinges per door		∅	Y / N	A / M / W	Walk / OH	L / R			Y N	Manual	Electric
(1)~2~3~4		∅	Y / N	A / M / W	Walk / OH	L / R			Set screw or Key	Lock	Y / N

Entry Number	Number of doors	Door ID	Access Card	Door Type	Walk / Over	Swing	Key System	Interior Hardware	Mullion Secure	Auto door closer	Auto door lock
3	2	(A)	Y / (N)	A/(M)W	Walk/OH	L / (R)	med	SPB	(Y) N	(Y) N	(Y) N
		(B)	(Y) N	A/(M)W	Walk/OH	(L) R	NO	SPB	Mullion Removable	Overhead Door	
Hinges per door		∅	Y / N	A / M / W	Walk / OH	L / R			(Y) N	Manual	Electric
(1)~2~3~4		∅	Y / N	A / M / W	Walk / OH	L / R			Set screw or Key	Lock	Y / N

med - medeco Key
 NO - NO Key
 CR - Corbin Russwin Key

SPB - Sargent Push bar
 HTL - handle thumb latch

1 - 41



SQL Server

We built SQL views to summarize inspections by week and visually indicate which doors had been inspected in the current week.

Column	Alias	Table	Outp...	Sort Type
WeekNumber		fnWeekN...	<input checked="" type="checkbox"/>	
StartDate		fnWeekN...	<input checked="" type="checkbox"/>	
EndDate		fnWeekN...	<input checked="" type="checkbox"/>	
DATEADD(day, 1, EndDate)	EndDat...		<input checked="" type="checkbox"/>	

WeekNumber	StartDate	EndDate	EndDateP1
14	2022-10-30 00:00:00.000	2022-11-05 00:00:00.000	2022-11-06 00:00:00.000
15	2022-11-06 00:00:00.000	2022-11-12 00:00:00.000	2022-11-13 00:00:00.000
16	2022-11-13 00:00:00.000	2022-11-19 00:00:00.000	2022-11-20 00:00:00.000
17	2022-11-20 00:00:00.000	2022-11-26 00:00:00.000	2022-11-27 00:00:00.000
18	2022-11-27 00:00:00.000	2022-12-03 00:00:00.000	2022-12-04 00:00:00.000
19	2022-12-04 00:00:00.000	2022-12-10 00:00:00.000	2022-12-11 00:00:00.000
20	2022-12-11 00:00:00.000	2022-12-17 00:00:00.000	2022-12-18 00:00:00.000

Week	Lab	cr
19	Fall 2022 Grade Period 2 Week 7	J
20	Fall 2022 Grade Period 2 Week 8	J
21	Winter Break 2022 Week 1	J
22	Winter Break 2022 Week 2	J
23	Spring 2023 Grade Period 3 Week 1	J
24	Spring 2023 Grade Period 3 Week 2	J
25	Spring 2023 Grade Period 3 Week 3	J
26	Spring 2023 Grade Period 3 Week 4	J
27	Spring 2023 Grade Period 3 Week 5	J
28	Spring 2023 Grade Period 3 Week 6	J
29	Spring 2023 Grade Period 3 Week 7	J
30	Spring 2023 Grade Period 3 Week 8	J
31	Spring 2023 Grade Period 3 Week 9	J
32	Spring 2023 Grade Period 3 Week 10	J
33	Spring Break 2023	J
34	Spring 2023 Grade Period 4 Week 1	J
35	Spring 2023 Grade Period 4 Week 2	J

SQL Server

Some of the views got a bit complex

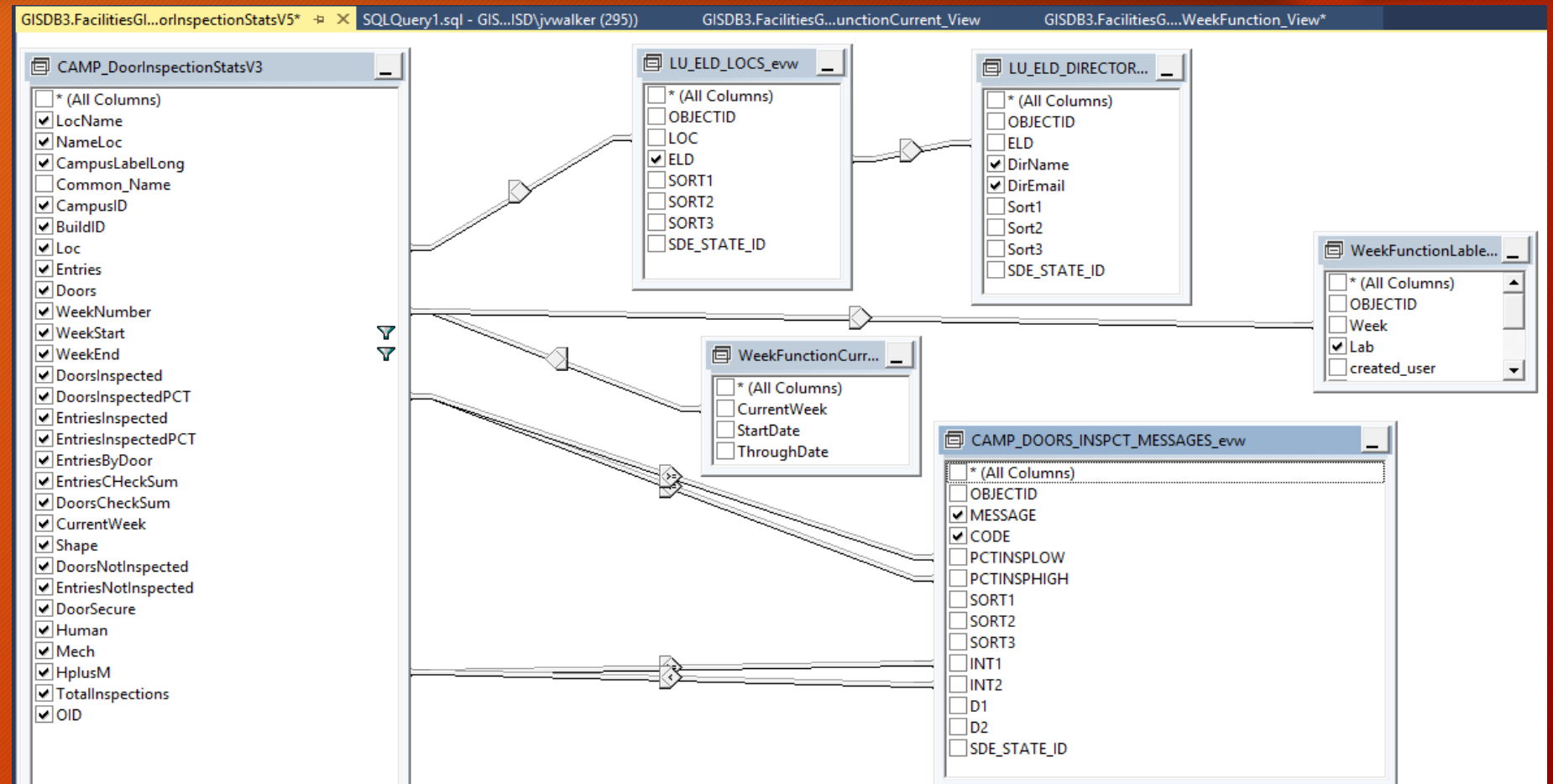

SQL Server

LocName	NameLoc	CampusLabel...	CampusID	BuildID	Loc	Entries	Doors	WeekNumber	WeekLab	WeekStart	WeekEnd	DoorsInspected	DoorsInspecte...	EntriesInspected	EntriesInspect...
157 - COUCH ES	COUCH ES - 157	COUCH ELEME...	157.1	ALL BUILDINGS	157	16	34	40	Spring 2023 Grade Period 4 Week 7	2023-04-30 00:0...	2023-05-02 14:5...	34	100.000000000000...	16	100.000000000000...
105 - CENTERVILLE ES	CENTERVILLE ES - 105	CENTERVILLE E...	105.1	ALL BUILDINGS	105	16	21	40	Spring 2023 Grade Period 4 Week 7	2023-04-30 00:0...	2023-05-02 14:5...	0	0.000000000000...	0	0.000000000000...
134 - NORTHLAKE ES	NORTHLAKE ES - 134	NORTHLAKE EL...	134.1	ALL BUILDINGS	134	30	44	40	Spring 2023 Grade Period 4 Week 7	2023-04-30 00:0...	2023-05-02 14:5...	0	0.000000000000...	0	0.000000000000...
047 - BRANDENBURG MS	BRANDENBURG MS - 047	BRANDENBUR...	047.1	ALL BUILDINGS	047	38	51	40	Spring 2023 Grade Period 4 Week 7	2023-04-30 00:0...	2023-05-02 14:5...	0	0.000000000000...	0	0.000000000000...
111 - KIMBERLIN ACADEMY ES	KIMBERLIN ACADEMY ES - 111	KIMBERLIN AC...	111.1	ALL BUILDINGS	111	11	19	40	Spring 2023 Grade Period 4 Week 7	2023-04-30 00:0...	2023-05-02 14:5...	0	0.000000000000...	0	0.000000000000...
102 - BULLOCK ES	BULLOCK ES - 102	BULLOCK ELEM...	102.1	ALL BUILDINGS	102	20	31	40	Spring 2023 Grade Period 4 Week 7	2023-04-30 00:0...	2023-05-02 14:5...	31	100.000000000000...	20	100.000000000000...
002 - GHS - FIELDHOUSE @ WILLIAMS	GHS - FIELDHOUSE @ WILLIAMS - 002	GARLAND HIG...	002.2	ALL BUILDINGS	002	29	35	40	Spring 2023 Grade Period 4 Week 7	2023-04-30 00:0...	2023-05-02 14:5...	0	0.000000000000...	0	0.000000000000...
043 - HOUSTON MS	HOUSTON MS - 043	HOUSTON MID...	043.1	ALL BUILDINGS	043	30	42	40	Spring 2023 Grade Period 4 Week 7	2023-04-30 00:0...	2023-05-02 14:5...	0	0.000000000000...	0	0.000000000000...
144 - KEELEY ES	KEELEY ES - 144	KEELEY ELEME...	144.1	ALL BUILDINGS	144	18	27	40	Spring 2023 Grade Period 4 Week 7	2023-04-30 00:0...	2023-05-02 14:5...	27	100.000000000000...	18	100.000000000000...
048 - SELLERS MS	SELLERS MS - 048	SELLERS MIDL...	048.1	ALL BUILDINGS	048	26	42	40	Spring 2023 Grade Period 4 Week 7	2023-04-30 00:0...	2023-05-02 14:5...	0	0.000000000000...	0	0.000000000000...
931 - NATATORIUM	NATATORIUM - 931	NATATORIUM	931.1	ALL BUILDINGS	931	14	23	40	Spring 2023 Grade Period 4 Week 7	2023-04-30 00:0...	2023-05-02 14:5...	0	0.000000000000...	0	0.000000000000...
053 - AEC	AEC - 053	GARLAND ALTE...	053.1	ALL BUILDINGS	053	11	13	40	Spring 2023 Grade Period 4 Week 7	2023-04-30 00:0...	2023-05-02 14:5...	13	100.000000000000...	11	100.000000000000...
158 - LIBERTY GROVE ES	LIBERTY GROVE ES - 158	LIBERTY GROVE...	158.1	ALL BUILDINGS	158	16	34	40	Spring 2023 Grade Period 4 Week 7	2023-04-30 00:0...	2023-05-02 14:5...	34	100.000000000000...	16	100.000000000000...
133 - HICKMAN ES	HICKMAN ES - 133	HICKMAN ELE...	133.1	ALL BUILDINGS	133	25	38	40	Spring 2023 Grade Period 4 Week 7	2023-04-30 00:0...	2023-05-02 14:5...	38	100.000000000000...	25	100.000000000000...
012 - GILBREATH-REED CTC	GILBREATH-REED CTC - 012	GILBREATH-RE...	012.1	ALL BUILDINGS	012	21	36	40	Spring 2023 Grade Period 4 Week 7	2023-04-30 00:0...	2023-05-02 14:5...	36	100.000000000000...	21	100.000000000000...
002 - GARLAND HS	GARLAND HS - 002	GARLAND HIG...	002.1	ALL BUILDINGS	002	74	112	40	Spring 2023 Grade Period 4 Week 7	2023-04-30 00:0...	2023-05-02 14:5...	0	0.000000000000...	0	0.000000000000...

But the results gave us what we needed to track and report.

EntriesByDoor	EntriesCheckS...	DoorsCheckSu...	CurrentWeek	Shape	DoorsNotInsp...	EntriesNotInsp...	DoorSecure	Human	Mech	HplusM	TotalInspections	MESSAGE	CODE	ELD	DirName	DirEmail	OID
16	16	34	40	POLYGON ((256...	0	0	34	0	0	0	34	Inspections Complete No Issues	4	EDLES1	Mrs. Kim Marsh	KLMarsh@garla...	400003576
16	16	21	40	POLYGON ((254...	21	16	0	0	0	0	0	Inspections Not Started	0	EDLES1	Mrs. Kim Marsh	KLMarsh@garla...	400001729
30	30	44	40	POLYGON ((254...	44	30	0	0	0	0	0	Inspections Not Started	0	EDLES3	Mrs. Cheryl Ale...	CLAlexan@garl...	400004847
38	38	51	40	POLYGON ((254...	51	38	0	0	0	0	0	Inspections Not Started	0	EDLMS1	Mrs. IDA Perales	iPerales@garla...	400004460
11	11	19	40	POLYGON ((254...	19	11	0	0	0	0	0	Inspections Not Started	0	EDLES3	Mrs. Cheryl Ale...	CLAlexan@garl...	400004034
20	20	31	40	POLYGON ((252...	0	0	31	0	0	0	31	Inspections Complete No Issues	4	EDLES1	Mrs. Kim Marsh	KLMarsh@garla...	400001643
29	29	35	40	MULTIPOLYGO...	35	29	0	0	0	0	0	Inspections Not Started	0	EDLHS1	Mr. Ray Merrill	RRMerril@garla...	400004485
30	30	42	40	POLYGON ((253...	42	30	0	0	0	0	0	Inspections Not Started	0	EDLMS1	Mrs. IDA Perales	iPerales@garla...	400004444
18	18	27	40	POLYGON ((257...	0	0	27	0	0	0	27	Inspections Complete No Issues	4	EDLES3	Mrs. Cheryl Ale...	CLAlexan@garl...	400003356
26	26	42	40	POLYGON ((254...	42	26	0	0	0	0	0	Inspections Not Started	0	EDLMS1	Mrs. IDA Perales	iPerales@garla...	400002706
14	14	23	40	POLYGON ((254...	23	14	0	0	0	0	0	Inspections Not Started	0	SEC	Security	Security	400001018
11	11	13	40	POLYGON ((254...	0	0	13	0	0	0	13	Inspections Complete No Issues	4	EDLMS1	Mrs. IDA Perales	iPerales@garla...	400003301
16	16	34	40	POLYGON ((257...	0	0	34	0	0	0	35	Inspections Complete No Issues	4	EDLES2	Dr. Kristin Wolf...	KEWolfki@garl...	400003610
25	25	38	40	POLYGON ((252...	0	0	38	0	0	0	38	Inspections Complete No Issues	4	EDLES1	Mrs. Kim Marsh	KLMarsh@garla...	400004846
21	21	36	40	POLYGON ((254...	0	0	36	0	0	0	36	Inspections Complete No Issues	4	EDLHS1	Mr. Ray Merrill	RRMerril@garla...	400002423

ESRI Field Maps deployed for door inspections

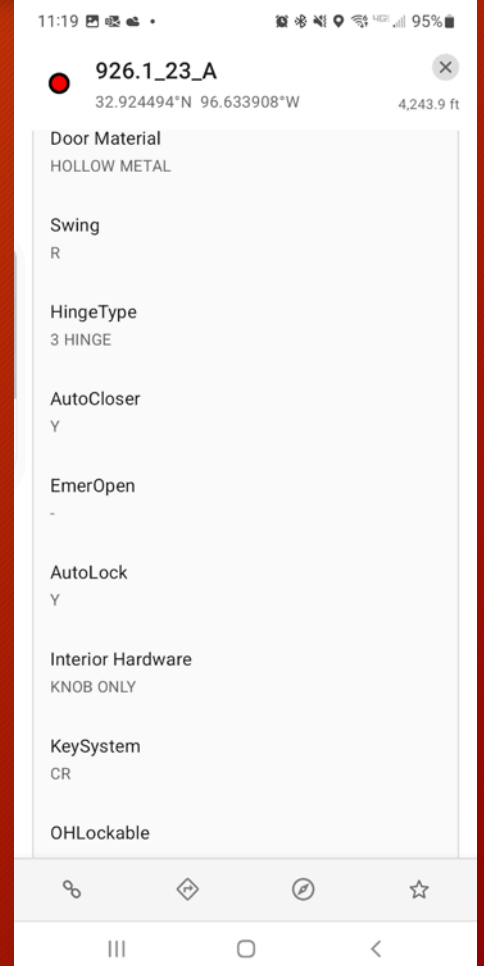
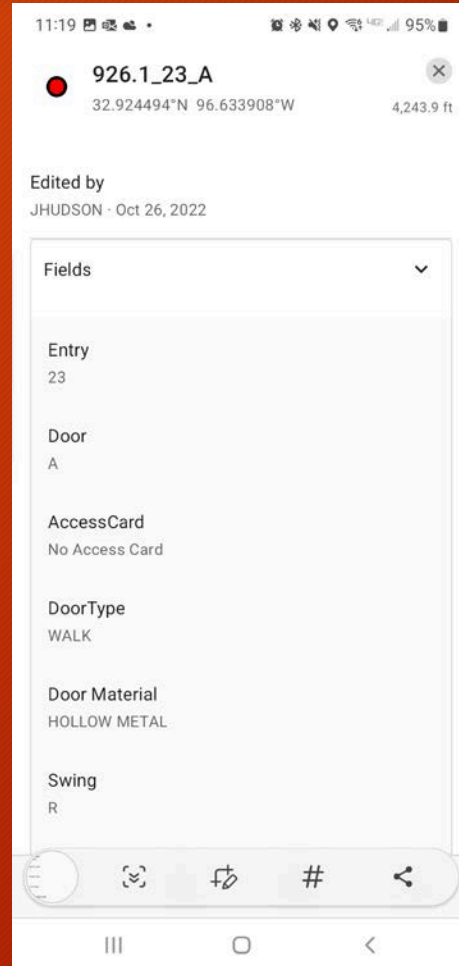
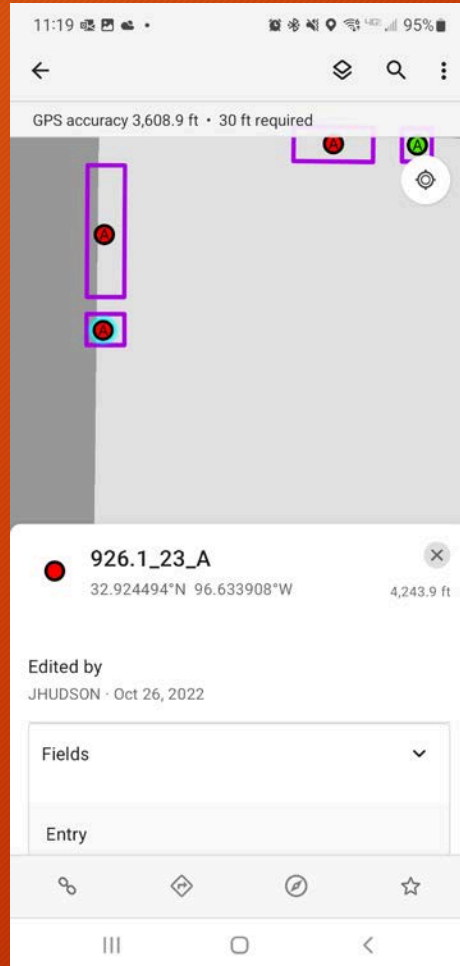
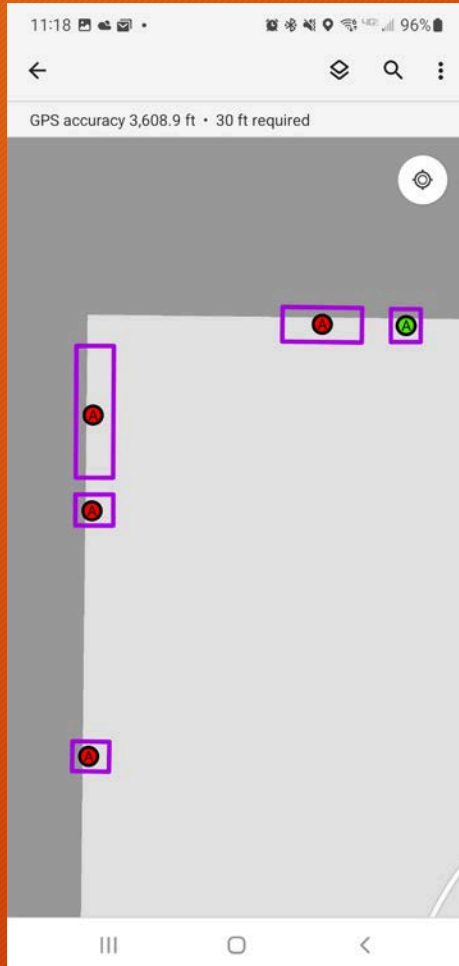
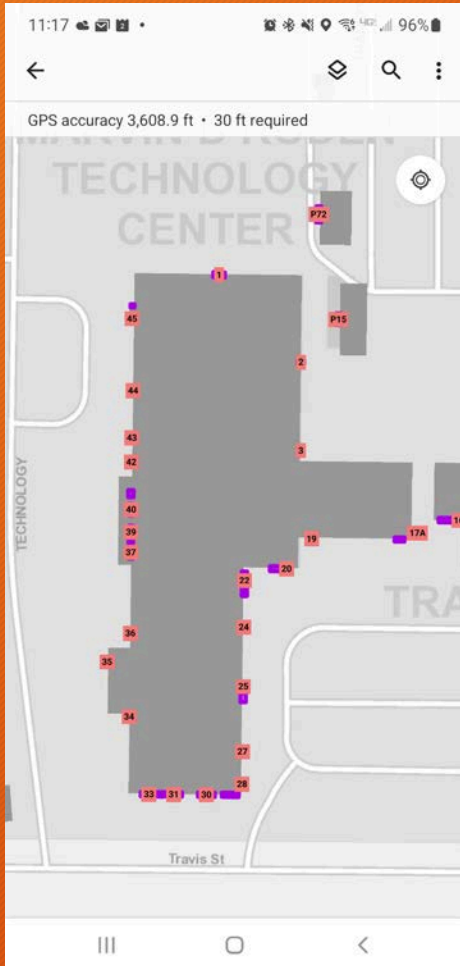

ESRI Field Maps deployed for door inspections

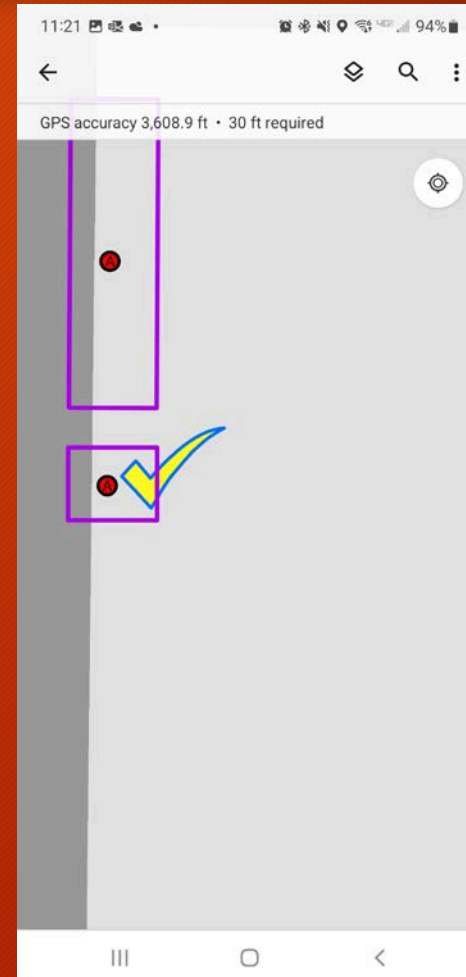
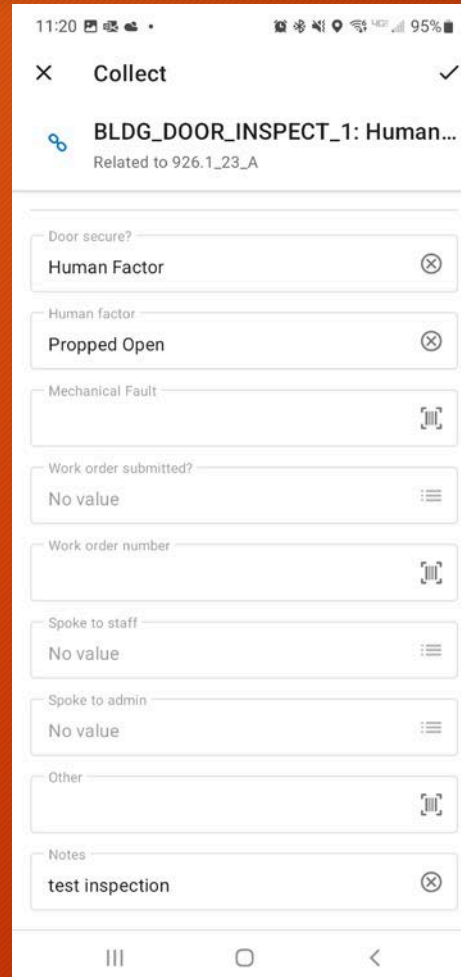
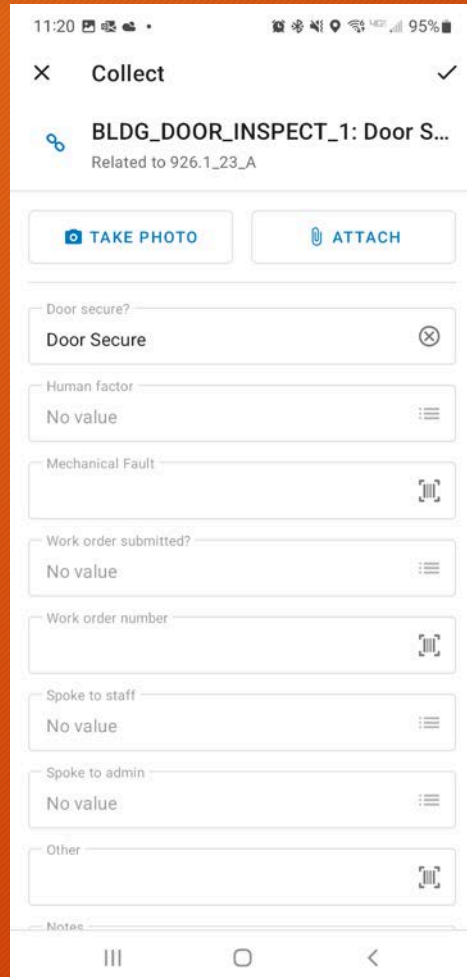
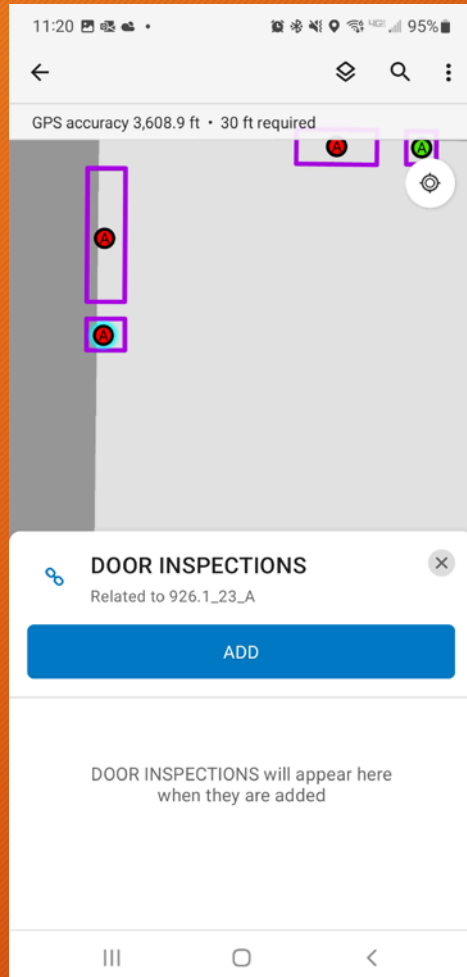

Field Maps works in IOS and Android, while the initial response to this app was positive it was decided that we could not proceed with out a desktop based inspection solution.

We needed a little help

We reached out to David McCourt at Softwhere Solutions for help developing a desktop app. This is what we came up with

Doors for GARLAND HS - 002

Spring 2023 Grade Period 4 Week 7 - Door Inspections
0 of 112 doors inspected this week.

Entry 1 - Door A
Last Inspected: ...
INSPECT

Entry 1 - Door B
Last Inspected: ...
INSPECT

Entry 2 - Door A
Last Inspected: ...
INSPECT

Entry 3 - Door A
Last Inspected: ...
INSPECT

Entry 3 - Door B
Last Inspected: ...
INSPECT

GARLAND HIGH SCHOOL

Inspect Entry 1 Door A

Is Door Secured?
 Yes No

SAVE NEXT DOOR RESET

Powered by Esri



<http://www.softwheresolutions.com/>

Campus privileges

One advantage that David's app has is that we can parse the CampusID through the URL to restrict users to only be able to inspect doors at campuses they have been given access to.

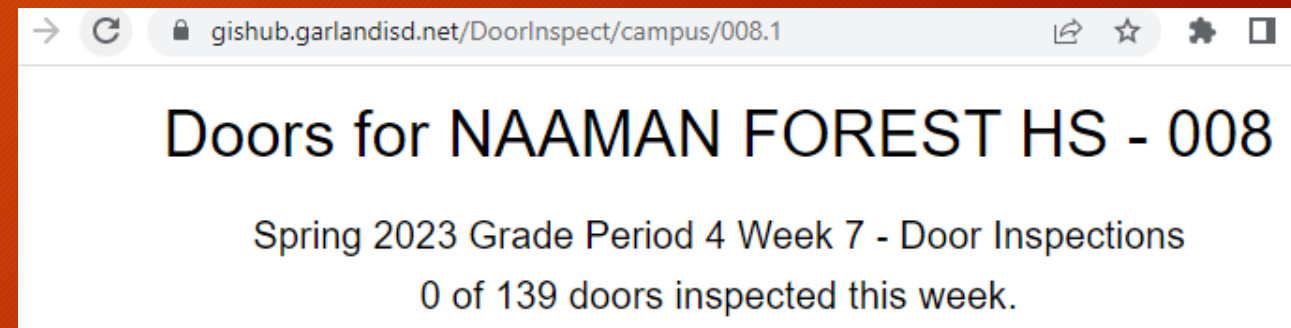
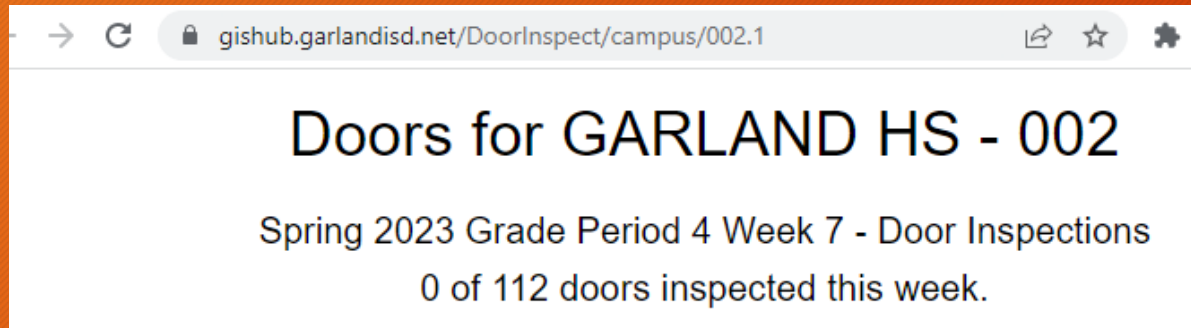

This meant that work needed to be done setting up privileges.

User Types, Roles, and Privileges

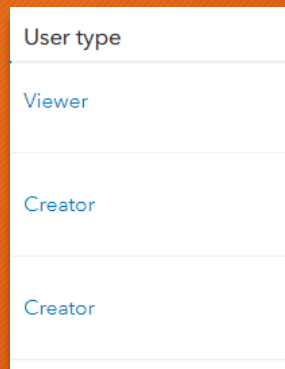

Assigned User Type

Controls the scope of privileges that can be assigned to the member through a role.

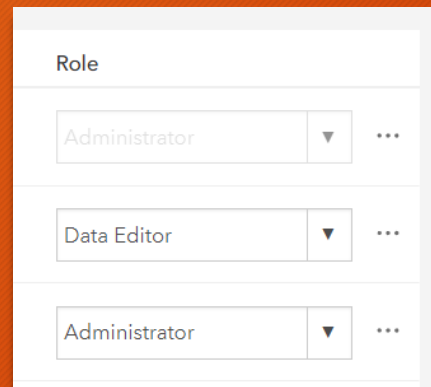

Roles

Type of work that members perform in the organization.



Privileges

Assigned to a role to grant specific rights to members. They control what a member can or cannot do in the organization.

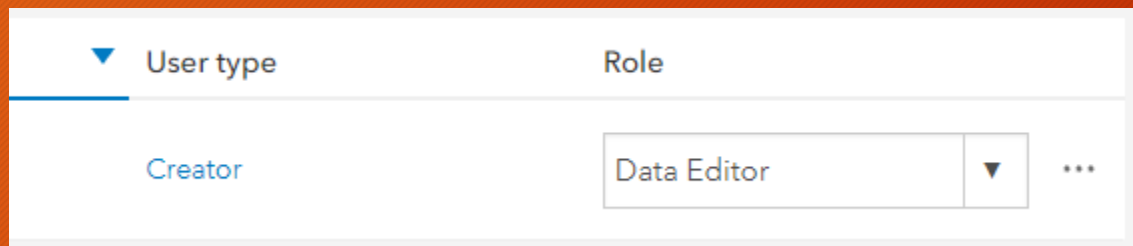

<https://doc.arcgis.com/en/arcgis-online/administer/roles.htm>

Groups were set up for each campus

- ✓ Define Group's Purpose
- ✓ Set Up Group
- ✓ Add Members
- ✓ Share Items

Get started creating groups



1 Define group's purpose



2 Set up group



3 Add members

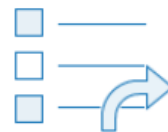

4 Share items

Credit:
<https://doc.arcgis.com/en/arcgis-online/get-started/get-started-with-groups.htm>

Data was shared to groups

Webmap, layers and individual campus URL was added to each group.

The image displays seven ArcGIS webmap thumbnails arranged in a 2x4 grid (with the last cell empty). Each thumbnail includes a title, author, creation and update dates, view count, and sharing options. The thumbnails are:

- Door Inspections 3**: by JWWalker@GISD, Created: Jan 3, 2023, Updated: Mar 3, 2023, View Count: 1,048. Thumbnail shows a world map.
- DoorInspCampusStatus**: by JWWalker@GISD, Created: Feb 28, 2023, Updated: Mar 2, 2023, View Count: 823. Thumbnail shows a white background with red squares.
- 008 Door Inspections**: by olesonr@GISD, Created: Feb 10, 2023, Updated: Feb 10, 2023, View Count: 0. Thumbnail shows a stick figure between two doors, one with a green checkmark and one with a red X.
- DoorInspect14**: by JWWalker@GISD, Created: Sep 28, 2022, Updated: Apr 10, 2023, View Count: 854. Thumbnail shows an aerial view of a campus.
- DoorInspect14**: by JWWalker@GISD, Created: Sep 28, 2022, Updated: Apr 10, 2023, View Count: 3,882. Thumbnail shows an aerial view of a campus.
- DoorInspectionChecksCurre...**: by JWWalker@GISD, Created: Nov 2, 2022, Updated: Dec 15, 2022, View Count: 1,241. Thumbnail shows a green checkmark.
- FLOORS**: by JWWalker@GISD, Created: Oct 16, 2020, Updated: Oct 16, 2020, View Count: 1,817. Thumbnail shows a black silhouette of a floor plan.

Users were added to their groups

Security provided a list of administrators from each campus who needed access to the app.

A separate list of security officers and SRO's were given access to do inspections for all schools.

Group pages were set up for each school.

The image displays a grid of ten group pages, each representing a different school or administrative function. Each page includes the school name, the number of inspections, and the user's email address. The pages are arranged in two rows of five.

School/Function	Inspections	User Email
155 ARMSTRONG ES	155	olesonr@GISD
156 PEARSON ES	156	olesonr@GISD
157 COUCH ES	157	olesonr@GISD
158 LIBERTY GROVE ES	158	olesonr@GISD
159 CARVER ES	159	olesonr@GISD
180 CISNEROS PRE-K	180	olesonr@GISD
181 PARSONS PRE-K	181	olesonr@GISD
Door Inspections	Garland ISD Campus door inspection app instructions	JVWalker@GISD
GISD Security Inspections Admin Status Page	Security Inspections Admin	JVWalker@GISD
GISD Security Inspections Security Department and SRO Access	Security Inspections Security Department and SRO Access	JVWalker@GISD

App instructions were sent to the schools

Garland ISD Campus door inspection app instructions

3/3/2023

Security and GIS have set up a campus door inspection app on our GIS app portal.

The GIS portal can be accessed from the Staff apps directory on your GISD desktop.

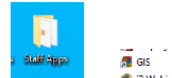

Or you can go to this web page from a district computer. <https://gishub.garlandisd.net/arcgis/home/>

On the GIS Portal home page, you will see a ribbon of app tiles.

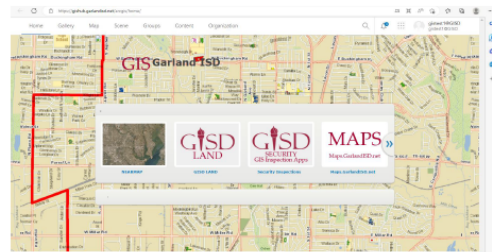

The apps on your page may be different if you have been given access to other GIS applications.

You can scroll through the apps available to you with the blue arrow on the edge of the app ribbon.



Find and click on the security inspections tile.

On the next page you will see a list of GISD campuses.

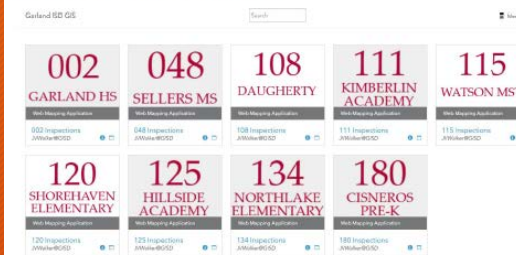

Click on your school.



On the page for your school you should see a door inspection link that looks like this.

If you do not see the link icon contact GISD-GISMaps@GarlandISD.net and request access



At the top of the inspection app you will see your schools name, the week and the door and inspection count for the week.

Below that the page is divided into three panels,

Left is a list of doors that can be inspected.

Center is an interactive map showing the doors.

Right is a blank space where the door inspections will be completed when you select a door.

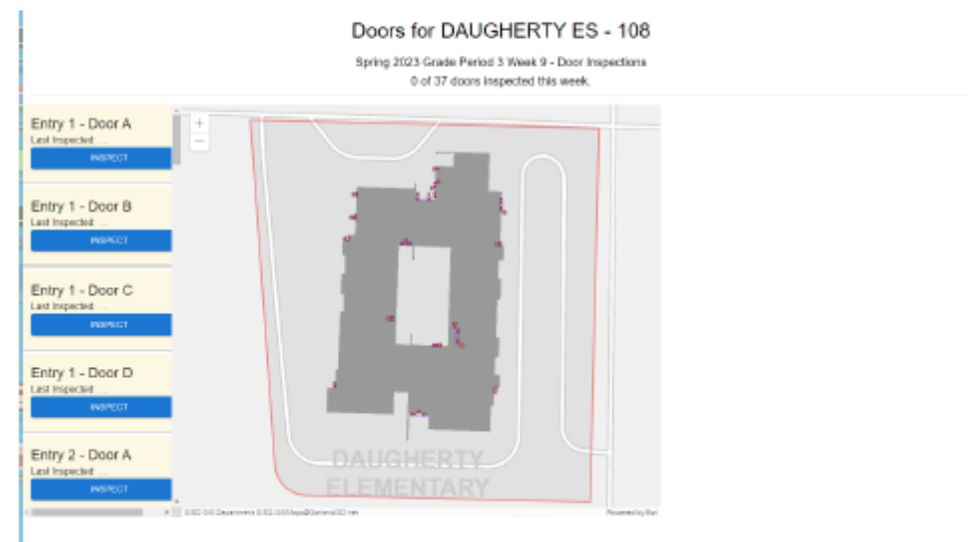

App instructions were sent to the schools

On the map you can zoom in and see the doors.

Below we have entry #1 which has 4 individual doors A, B, C, and D. We can also see that Mullions exist between A-B and C-D.

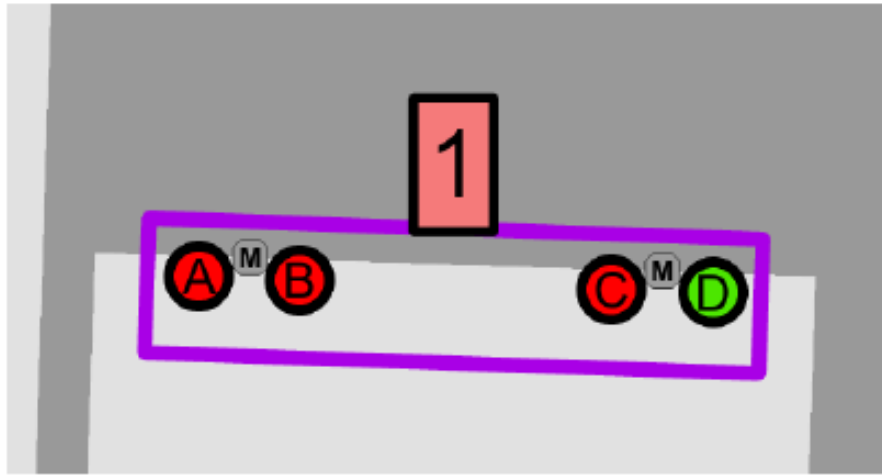

Doors for DAUGHERTY ES - 108

Spring 2023 Grade Period 3 Week 8 - Door Inspections
0 of 57 doors inspected this week.

Entry 1 - Door A
Last Inspected: [button: INSPECT]

Entry 1 - Door B
Last Inspected: [button: INSPECT]

Entry 1 - Door C
Last Inspected: [button: INSPECT]

Entry 1 - Door D
Last Inspected: [button: INSPECT]

Entry 2 - Door A
Last Inspected: [button: INSPECT]

Inspect Entry 1 Door A

Is Door Secured?
 Yes No

[button: SAVE] [button: NEXT DOOR] [button: RESET]

Instructions had to be detailed

Inspect Entry 1 Door A

Is Door Secured?
 Yes No

Reason Unsecured

Human Factor

Mechanical Fault

Work Order submitted?
 Yes No

work order number

Spoke to staff?
 Yes No

Spoke to admin?
 Yes No

Other

Notes

Inspect Entry 1 Door A

Is Door Secured?
 Yes No

Reason Unsecured

Human Factor

Mechanical Fault

Work Order submitted?
 Yes No

work order number

Spoke to staff?
 Yes No

Spoke to admin?
 Yes No

Other

Notes

Inspect Entry 1 Door A

Is Door Secured?
 Yes No

Reason Unsecured

Human Factor

Mechanical Fault

Work Order submitted?
 Yes No

work order number

Spoke to staff?
 Yes No

Spoke to admin?
 Yes No

Other

Notes

Indicators in the app help users keep up with inspection progress

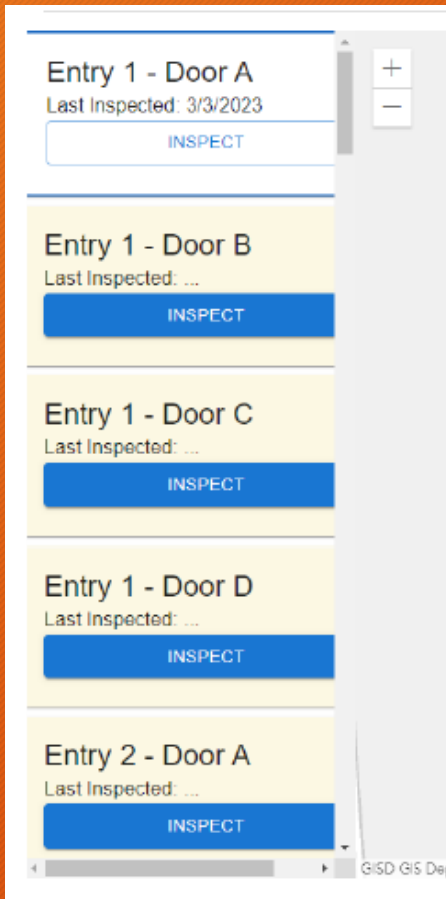

Doors for DAUGHERTY ES - 108

Spring 2023 Grade Period 3 Week 9 - Door Inspections
36 of 37 doors inspected this week.

Check boxes in the web map and summary data by week leverage the SQL views.

Inspected doors will also show small check marks on the map.

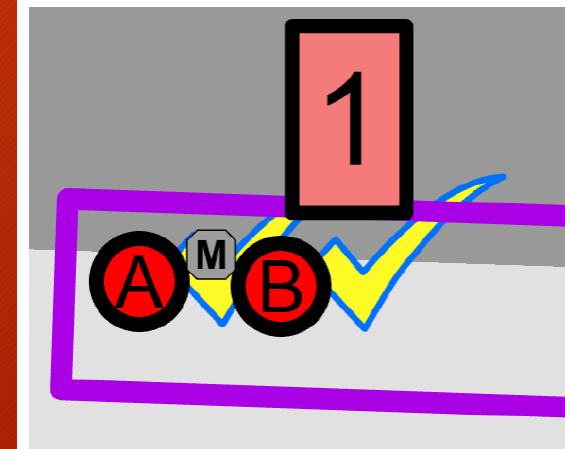

Reporting was the next step

For this we reached out to New Edge Services.

We worked with Robbie Schermerhorn to design and build reports in Crystal Reports.

Robbie implemented a tool called Crystal Delivery Pro.

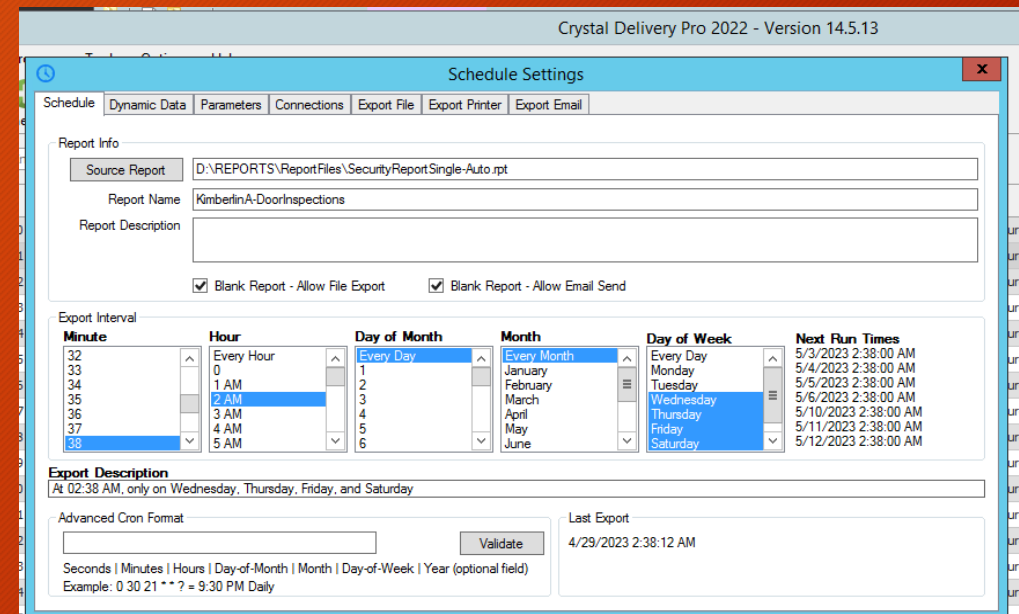

<https://www.newedgeservices.com/>

Each campus gets a detail report Wednesday through Friday and a final weeks report is generated Saturday morning

Spring 2023 Grade Period 4 Week 3
4/2/23 - 4/3/23

Report Date: 4/3/2023

INSPECTION STATISTICS					
<u>Total Doors</u>	<u>Doors Inspected</u>	<u>Door Inspection %</u>	<u>Total Entries</u>	<u>Entries Inspected</u>	<u>Entry Inspection %</u>
45	45	100.00%	34	34	100.00%

2.22% of Doors

Human Fault						
<u>Door #</u>	<u>Issue Type</u>	<u>WO #</u>	<u>Staff</u>	<u>Admin</u>	<u>Other</u>	<u>Notes</u>
P004L A	Unlocked		Y	Y		

Secured						
<u>Door #</u>	<u>Issue Type</u>	<u>WO #</u>	<u>Staff</u>	<u>Admin</u>	<u>Other</u>	<u>Notes</u>
1 A	No Issue		N	N		
1 B	No Issue		N	N		
1 C	No Issue		N	N		
1 D	No Issue		N	N		
2 A	No Issue		N	N		
2 B	No Issue		N	N		

Spring 2023 Grade Period 4 Week 3
4/2/23 - 4/8/23

Report Date: 4/8/2023

INSPECTION STATISTICS					
<u>Total Doors</u>	<u>Doors Inspected</u>	<u>Door Inspection %</u>	<u>Total Entries</u>	<u>Entries Inspected</u>	<u>Entry Inspection %</u>
139	137	98.60%	92	90	97.80%

98.56% of Doors

Secured						
<u>Door #</u>	<u>Issue Type</u>	<u>WO #</u>	<u>Staff</u>	<u>Admin</u>	<u>Other</u>	<u>Notes</u>
1 A	No Issue		N	N		
1 B	No Issue		N	N		
1 C	No Issue		N	N		
1 D	No Issue		N	N		
2 A	No Issue		N	N		
2 B	No Issue		N	N		
WR9 A	No Issue		N	N		

Not Inspected						
<u>Door #</u>	<u>Issue Type</u>	<u>WO #</u>	<u>Staff</u>	<u>Admin</u>	<u>Other</u>	<u>Notes</u>
44 A						
45 A						

1.44% of Doors

Directors get summary reports

Area Directors Report
Weekly Door Inspections Stats
Mrs. Kim Marsh
Spring 2023 Grade Period 4 Week 6
04/23/2023 - 04/28/2023

Report Date: 4/28/2023

BULLOCK ELEMENTARY SCHOOL CAMPUS - 102

<u>Total Doors</u>	<u>Doors Inspected</u>	<u>Door Inspection %</u>	<u>Doors Secure</u>	<u>Human Errors</u>	<u>Mechanical Faults</u>
31	31	100.00%	31	0	0

CALDWELL ELEMENTARY SCHOOL CAMPUS - 103

<u>Total Doors</u>	<u>Doors Inspected</u>	<u>Door Inspection %</u>	<u>Doors Secure</u>	<u>Human Errors</u>	<u>Mechanical Faults</u>
30	30	100.00%	30	0	0

CENTERVILLE ELEMENETARY SCHOOL CAMPUS - 105

<u>Total Doors</u>	<u>Doors Inspected</u>	<u>Door Inspection %</u>	<u>Doors Secure</u>	<u>Human Errors</u>	<u>Mechanical Faults</u>
21	21	100.00%	21	0	0

CISNEROS PRE-K SCHOOL CAMPUS - 180

<u>Total Doors</u>	<u>Doors Inspected</u>	<u>Door Inspection %</u>	<u>Doors Secure</u>	<u>Human Errors</u>	<u>Mechanical Faults</u>
30	30	100.00%	30	0	0

CLUB HILL ELEMENTARY SCHOOL CAMPUS - 132

<u>Total Doors</u>	<u>Doors Inspected</u>	<u>Door Inspection %</u>	<u>Doors Secure</u>	<u>Human Errors</u>	<u>Mechanical Faults</u>
24	24	100.00%	24	0	0

COUCH ELEMENTARY SCHOOL CAMPUS - 157

<u>Total Doors</u>	<u>Doors Inspected</u>	<u>Door Inspection %</u>	<u>Doors Secure</u>	<u>Human Errors</u>	<u>Mechanical Faults</u>
52	30	57.70%	30	0	0

<u>Total Doors</u>	<u>Doors Inspected</u>	<u>Door Inspection %</u>	<u>Doors Secure</u>	<u>Human Errors</u>	<u>Mechanical Faults</u>
51	51	100.00%	48	3	0

<u>Total Doors</u>	<u>Doors Inspected</u>	<u>Door Inspection %</u>	<u>Doors Secure</u>	<u>Human Errors</u>	<u>Mechanical Faults</u>
29	29	100.00%	28	1	0

Security requested a dashboard

We used ArcGIS Insights to give Security the real time status of campus by campus door inspections.

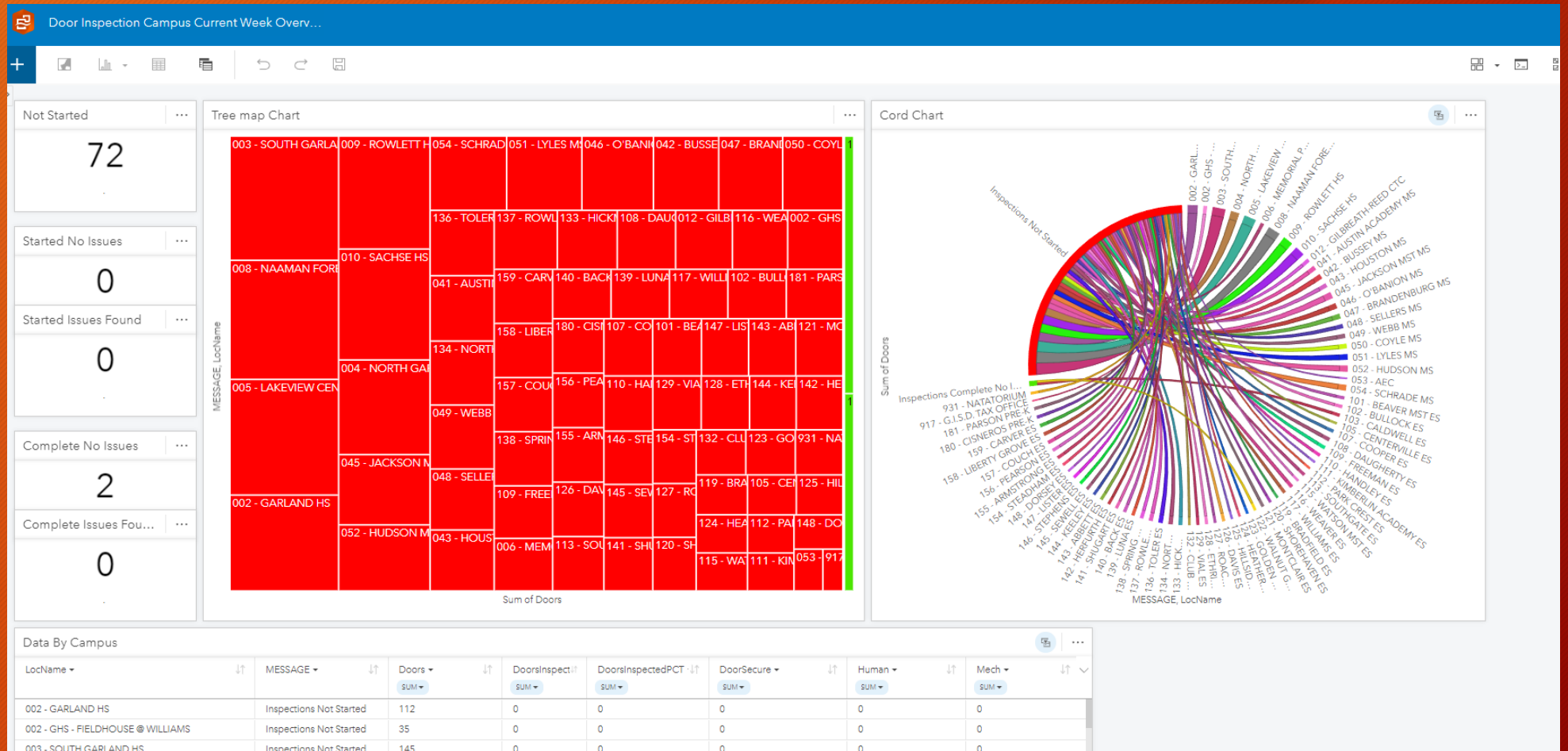

Security requested a dashboard

Color coding in the Tree Map Chart and Cord Chart changes as inspections are done.

- Red = No inspections
- Orange = Inspections started and problems found
- Yellow = inspections started no problems
- Green is inspections complete no problems
- Blue = inspections complete with problems

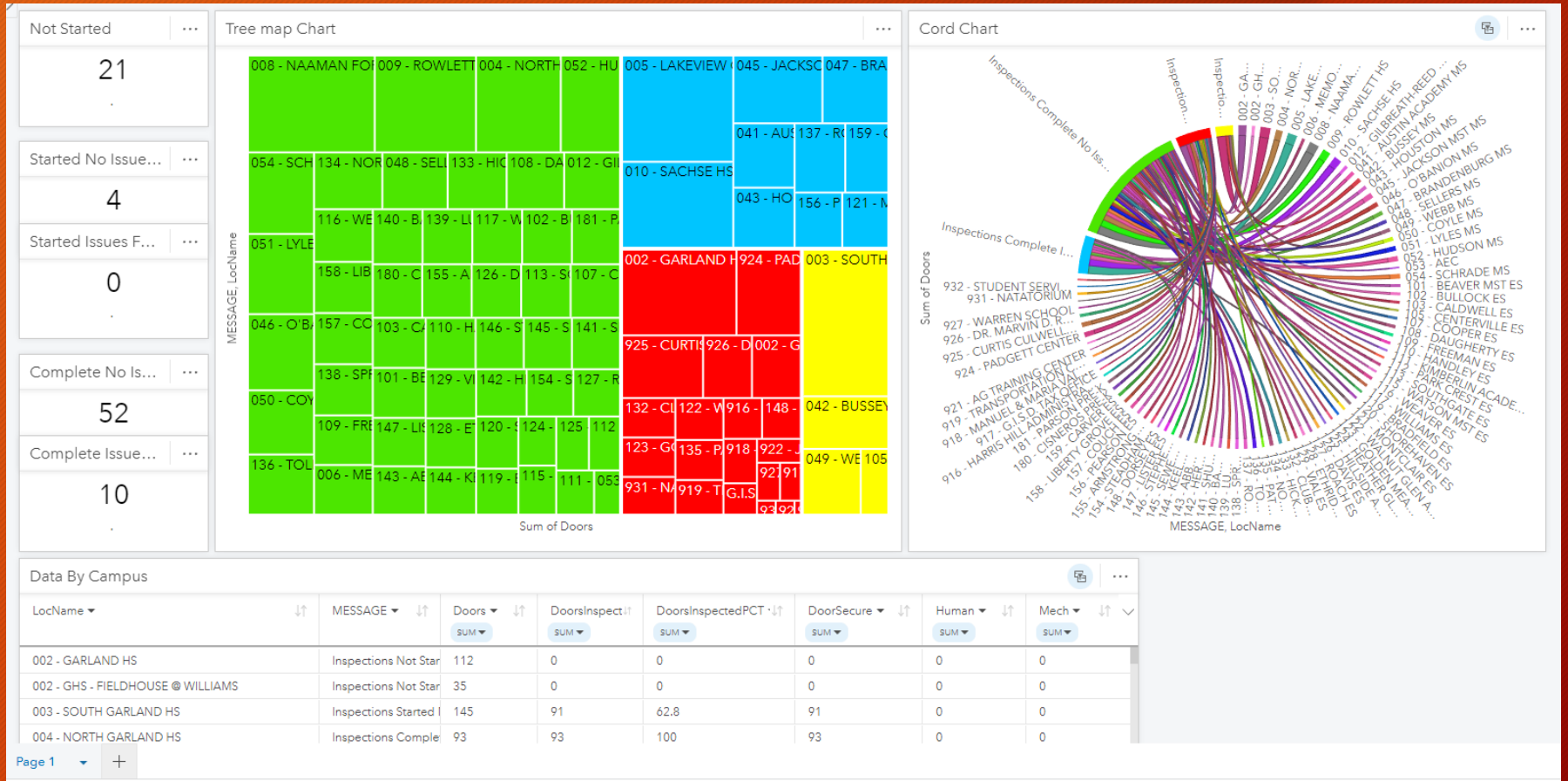

Questions and contact info



James Walker
GIS Program Manager
Garland ISD
JVWalker@garlandisd.net
(972) 487-3692 Office
(972) 838-3717 Cell

Mark Quinn
Director of Security
Garland ISD
Office #972-487-4110
Fax #972-494-8627
mquinn@garlandisd.net
Asksecurity@garlandisd.net

David McCourt
Softwhere Solutions
469-955-6116
david@softwheresolutions.com



Robert Oleson
GISD GIS Department
GIS Auto Cad Technician
OlesonR@garlandisd.net
972-487-3685

NewEdge Services, LLC
(469) 766-3732
Info@newedgeservices.com

